



Calfield Business Center

16960–17110 W Greenfield Avenue
Brookfield, WI 53005



About the Property

Calfield Business Center is comprised of three office/retail buildings totaling 49,526 square feet of space and is located along the Interstate 94 corridor in Waukesha County. The property is located just minutes from Waukesha County Airport, the Waukesha County offices, and the Interstate 94 and Highway 164 interchange.



Office/Retail Buildings

17110 W Greenfield Avenue	17,211 SF
17040 W Greenfield Avenue	15,104 SF
16960 W Greenfield Avenue	17,211 SF

Building Specifications

Ceiling Height	12 ft. clear minimum
Parking	5.9 spaces/1,000 SF
Construction	Masonry
Zoning	B-1

For more information on Calfield Business Center, visit: sjpi.com/calfield



Total SF Available:
2,324 SF

*Private offices (9), dedicated
reception, and waiting room*

*Note: This space plan is subject to existing
field conditions. This drawing is proprietary
and the exclusive property of St. John
Properties, Inc. Any duplications, distribution,
or other unauthorized use is strictly prohibited.*

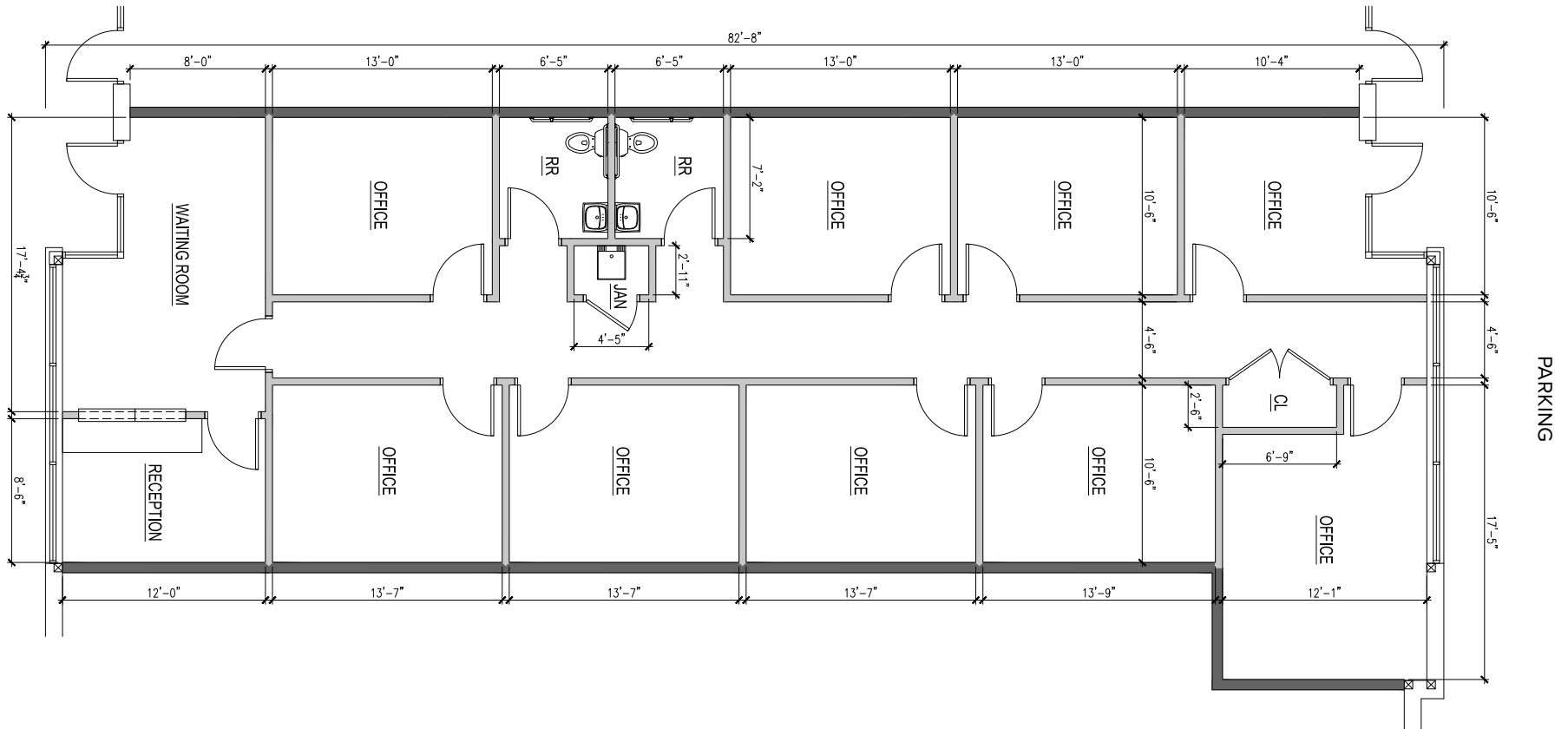

Availabilities

Office/Retail Space at Calfield Business Center

2,324 sq. ft.	17110 W Greenfield Avenue	Suite 2	Private offices (9), dedicated reception, and waiting room
---------------	---------------------------	---------	--

Contact Us

Gregory Fax

Regional Partner, Wisconsin

GFax@sjpi.com | 262.524.0100

Wisconsin Regional Office:

2000 Pewaukee Road | Suite A

Waukesha, WI 53188



262.524.0100 | SJPI.COM/WISCONSIN

