

Discovery District
5600 Rivertech Court | Cockeysville, MD 21030
Suites H-J

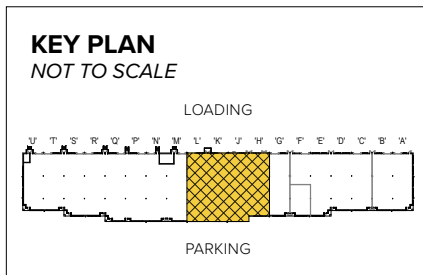

Total SF Available:
11,877 SF

Office/flex space currently built out with 100% office, ability to add dock height and/or at-grade drive-in doors, if needed



Note: This space plan is subject to existing field conditions. This drawing is proprietary and the exclusive property of St. John Properties, Inc. Any duplications, distribution, or other unauthorized use is strictly prohibited.

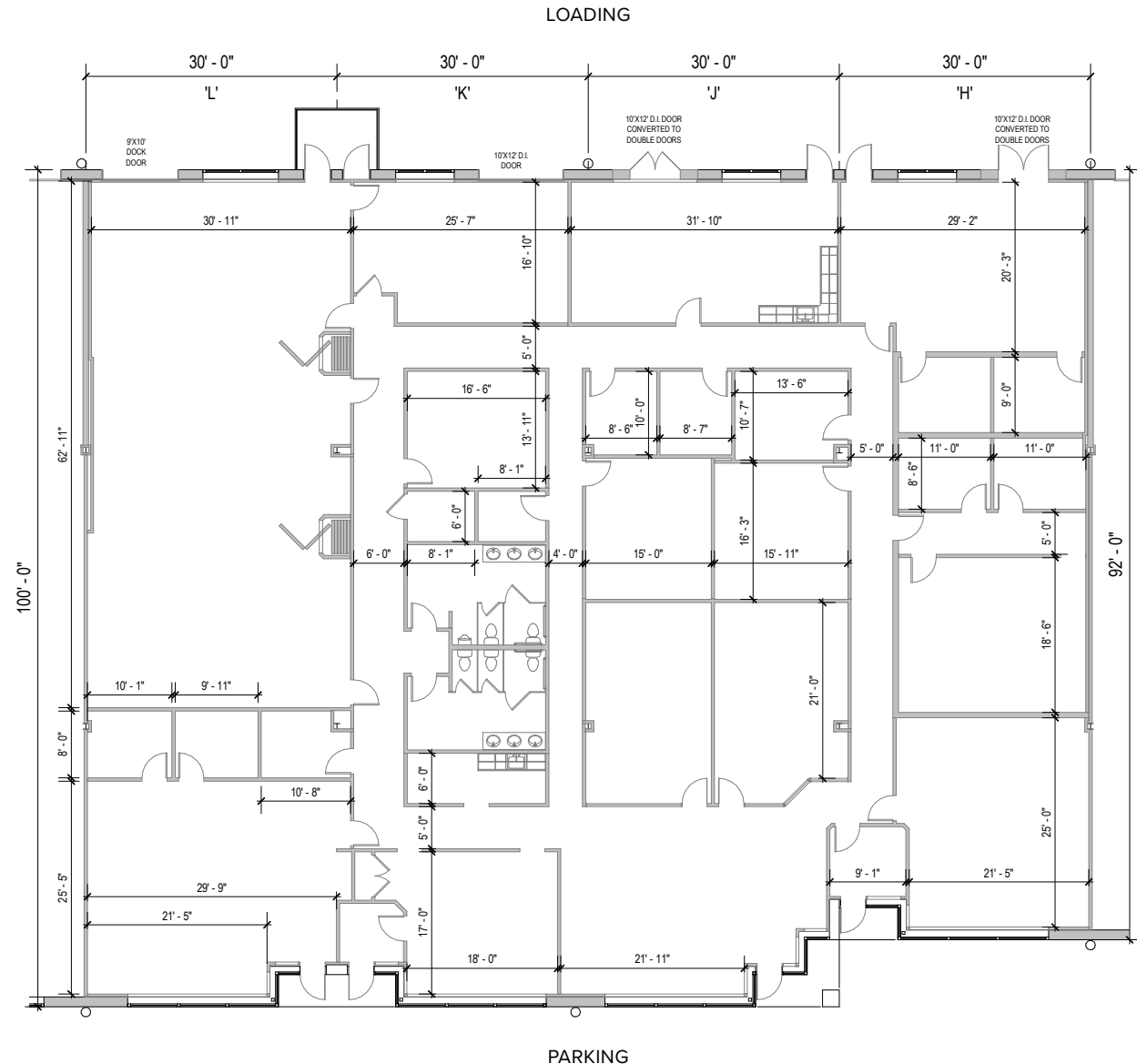



Rivertech Court at Discovery District

Set in the 150-acre Discovery District at the University of Maryland, Rivertech Court's three flex/R&D buildings are comprised of over 159,000 square feet of space. Each building offers dock and drive-in loading capabilities, 16 foot clear minimum ceiling heights, free parking and data connectivity to ISP providers via fiber backbone.

For more information on Rivertech Court at the Discovery District, visit: sjpi.com/rivertechcourt



Erco Memorial Park

Flex/R&D Buildings		
5600 Rivertech Court	52,680 SF	LEED GOLD
5650 Rivertech Court	57,120 SF	LEED GOLD
5751 Rivertech Court	50,107 SF	LEED GOLD
Flex/R&D Specifications		
LEED	Gold Core & shell	
Suite Sizes	2,520 up to 57,120 SF	
Ceiling Height	16 ft. clear minimum	
Parking	4 spaces per 1,000 SF	
Construction	Brick on block	
Roof	TPO	
Loading	Dock or drive-in	



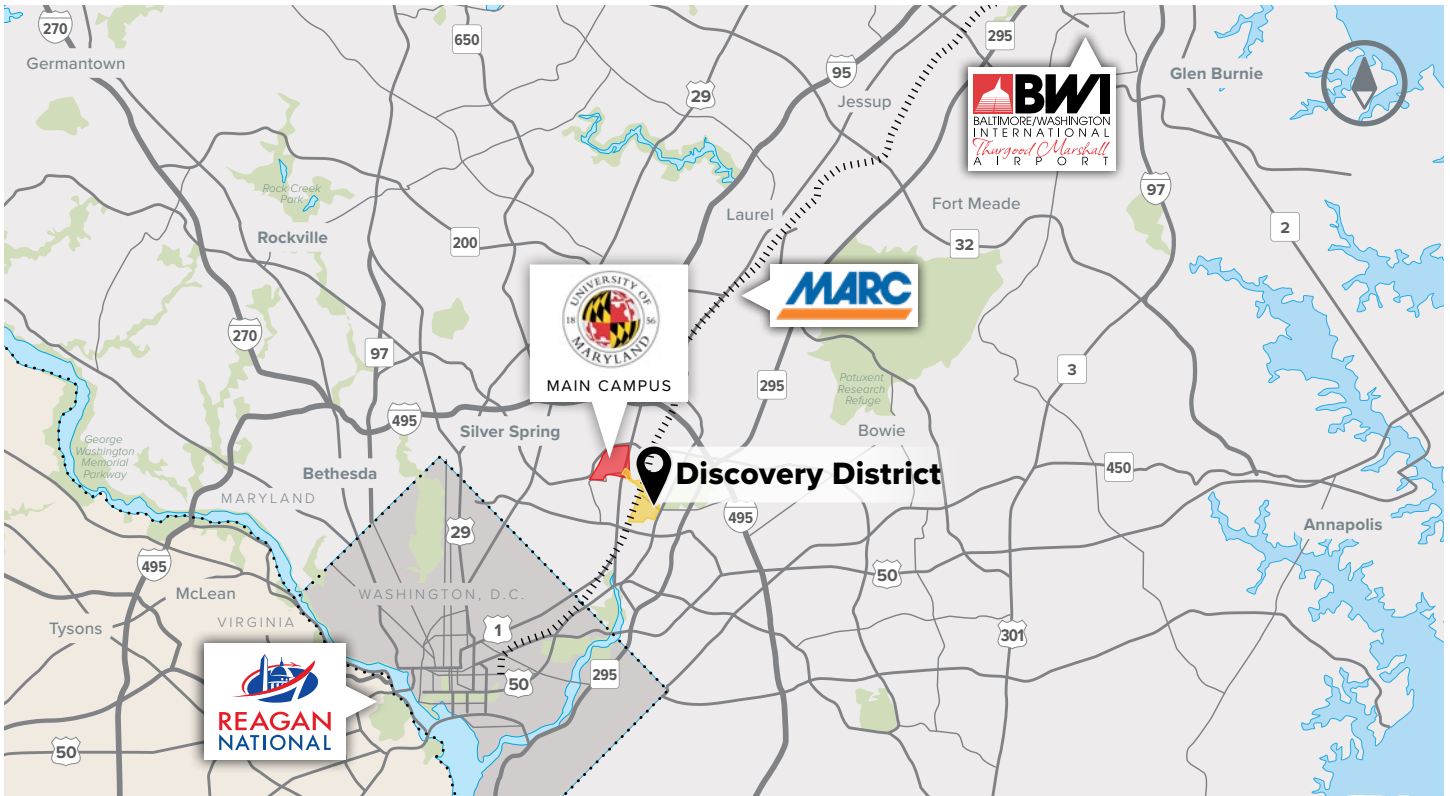

Distances to:

College Park Airport	1 mile
Metro/MARC	1 mile
UMD College Park Main Campus	1 mile
Interstate 495 (Capital Beltway)	3.5 miles
MD 295	4 miles
Interstate 95	7.5 miles
Washington, D.C. (Downtown)	11 miles
BWI Airport	24 miles
Interstate 695 (Baltimore Beltway)	25 miles
Baltimore, MD (Downtown)	35 miles



Scan with your mobile device to take a virtual tour, download floor plans and more!

Contact Us

For additional leasing information or to schedule a tour, contact:

Claire Metz

Leasing Representative

CMetz@sjpi.com | 410.369.1274

Corporate Headquarters:

2560 Lord Baltimore Drive | Baltimore, MD 21244

410.788.0100 | SJPI.COM

About St. John Properties

St. John Properties, Inc. is one of the nation's largest and most successful privately held commercial real estate firms. The company owns, manages, and has developed office, flex/research and development, warehouse, retail, and multifamily space nationwide.

Connect with us @stjohnprop



This information contained in this publication has been obtained from sources believed to be reliable. St. John Properties makes no guarantee, warranty or representation about this information. Any projections, opinions, assumptions or estimates used here are for example only and do not represent the current or future performance of the property. Interested parties should conduct an independent investigation to determine whether the property suits their needs. REV 12/25