

Valley Grove

2100 W. Pleasant Grove Boulevard | Pleasant Grove, UT 84062

Suite 100 | First Floor



Total SF Available:

14,731 SF

Efficient office space with dedicated reception area, private offices, open office areas, and break room

KEY PLAN NOT TO SCALE

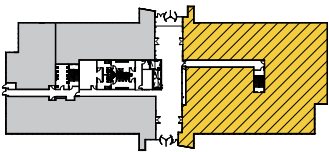

Note: This space plan is subject to existing field conditions. This drawing is proprietary and the exclusive property of St. John Properties, Inc. Any duplications, distribution, or other unauthorized use is strictly prohibited.



Grove Tower

Six-Story Class ‘A’ Office

Grove Tower	
2100 W Pleasant Grove Blvd	189,595 SF
Six-Story Office Specifications	
LEED	Certified
Suite Sizes	2,500 up to 189,783 SF
Ceiling Height	10-13 ft. clear minimum
Offices	Built to suit
Parking	5.5 spaces per 1,000 SF



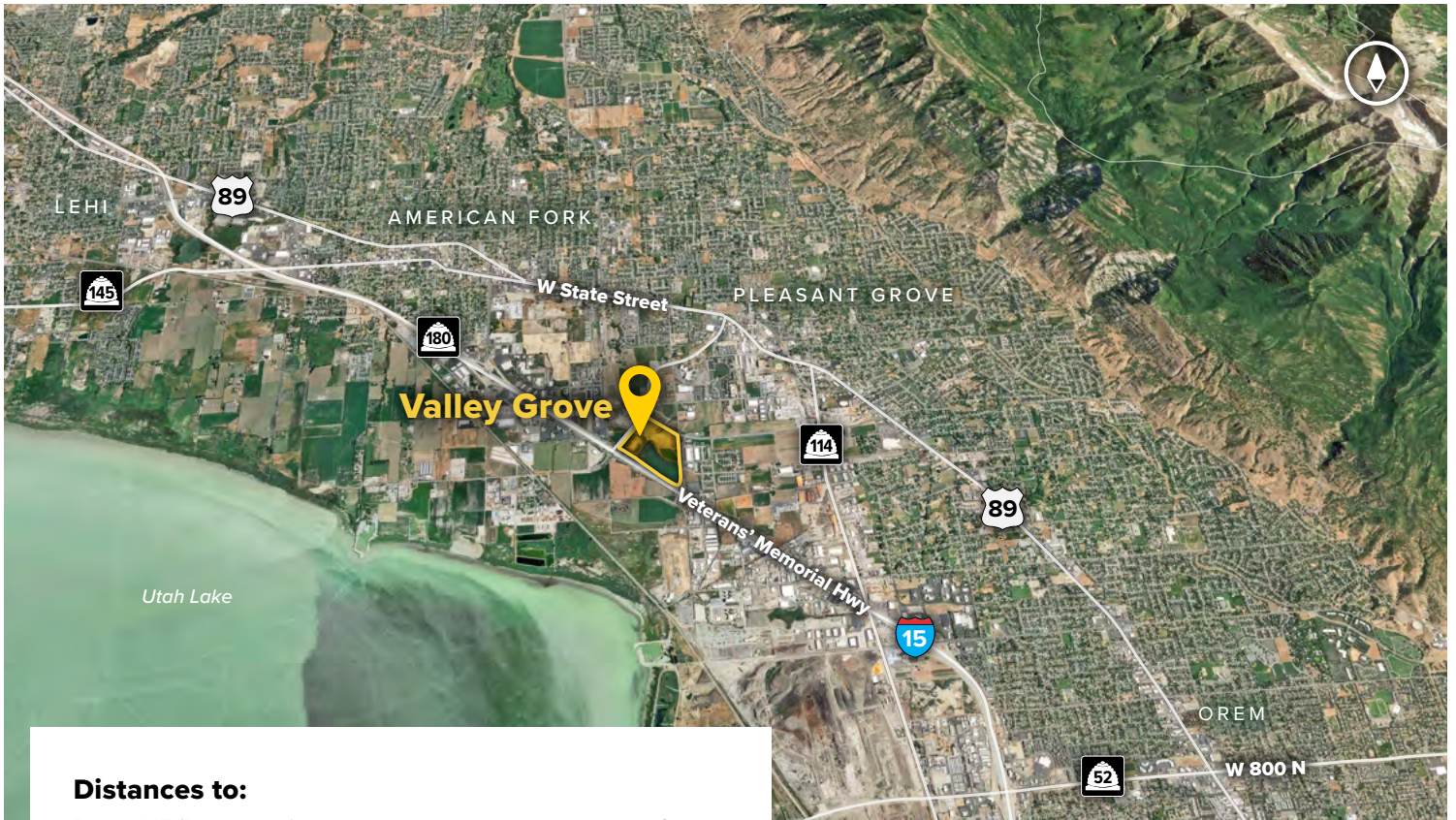

Distances to:

Provo, UT (Downtown)	12 miles
Interstate 215	25 miles
Salt Lake City, UT (Downtown)	34.5 miles
Salt Lake City International Airport	38 miles



Scan now to take a virtual tour, download floor plans and more!

Contact Us

Scott Gifford

Assistant Vice President of Leasing
SGifford@sjpi.com | 801.899.7991

Daniel Thomas

Regional Partner
DThomas@sjpi.com | 801.899.7991

Utah Office:

1064 S North County Boulevard | Suite 190
Pleasant Grove, Utah 84062

801.899.7991 | SJPI.COM/UTAH

About St. John Properties

St. John Properties, Inc. is one of the nation's largest and most successful privately held commercial real estate firms. Founded in 1971, the vertically-integrated company develops, owns and manages office, flex/ research and development, warehouse, retail and multifamily space nationwide.

Connect with us @stjohnprop

