



4125 N 124th Street

Brookfield, WI 53005



About the Property

4125 N 124th Street offers 23,414 square feet of high image office/flex space with excellent visibility along 124th Street in Brookfield. The property provides easy access to Interstate 45 and is just two minutes from Zoo Freeway and Capitol Drive, with close proximity to retail amenities and convenient connections to General Mitchell International Airport and Interstate 94.



Flex/R&D/Office Building

4125 N 124th Street	23,414 SF
---------------------	-----------

Building Specifications

Ceiling Height	14 ft. clear minimum
Parking	4 spaces/1,000 SF
Construction	Masonry
Loading	Drive-in
Zoning	I-Industrial

For more information on 4125 N 124th Street, visit: sjpi.com/124street



Total SF Available:
1,393 SF

*Private offices (2), open
office area, storage room,
and private restroom*

Note: This space plan is subject to existing field conditions. This drawing is proprietary and the exclusive property of St. John Properties, Inc. Any duplications, distribution, or other unauthorized use is strictly prohibited.

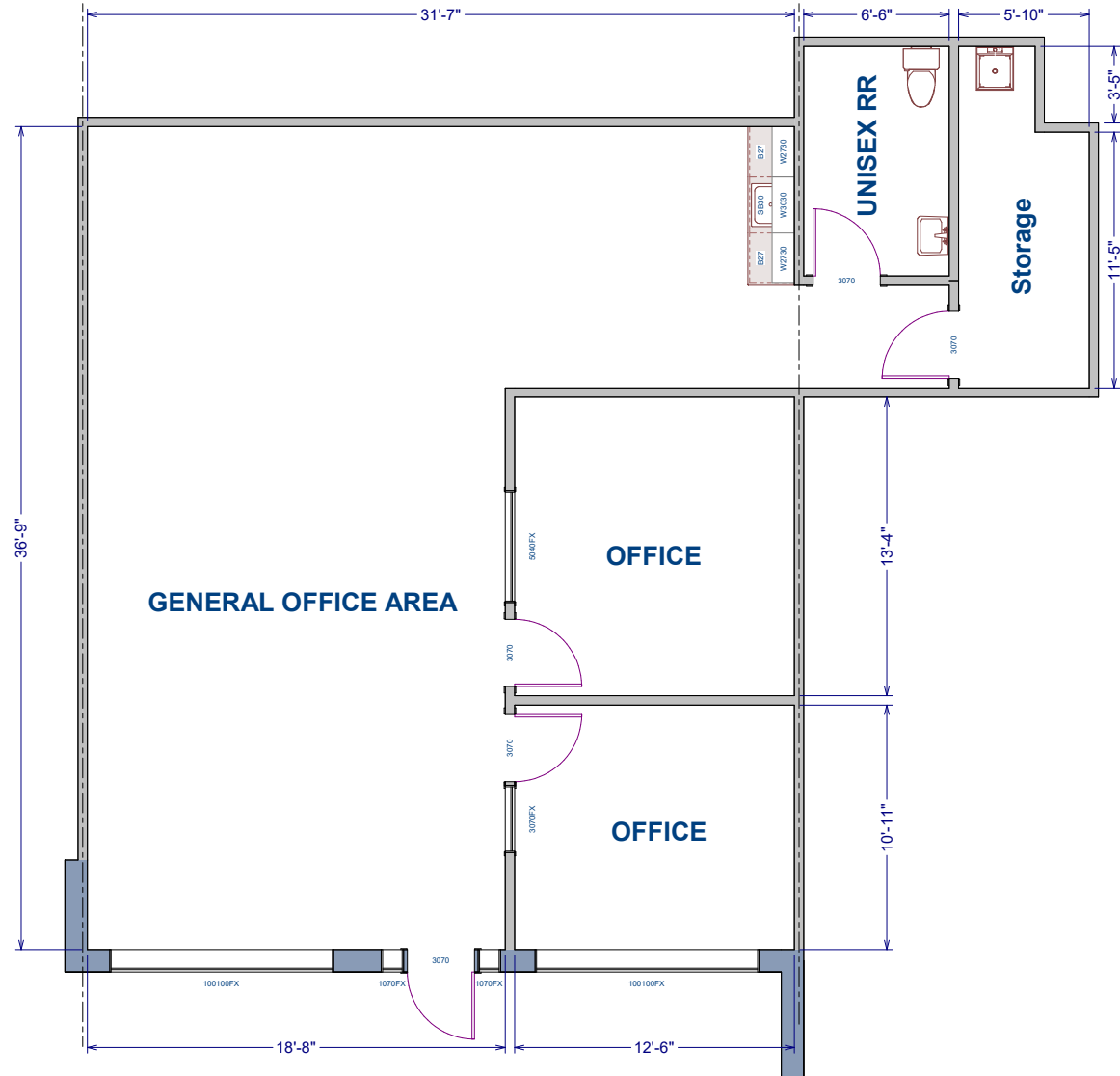

Availabilities

Flex/R&D/Office Space at 4125 N 124th Street

1,393 sq. ft.	4125 N 124th Street	Suite I	Private offices (2), open office area, storage room, and private restroom
2,347 sq. ft.	4125 N 124th Street	Suite G	Office/flex space with front reception area, private offices, and private restrooms

Contact Us

Gregory Fax

Regional Partner, Wisconsin

GFax@sjpi.com | 262.524.0100

Wisconsin Regional Office:

2000 Pewaukee Road | Suite A

Waukesha, WI 53188



262.524.0100 | SJPI.COM/WISCONSIN



This information contained in this publication has been obtained from sources believed to be reliable. St. John Properties makes no guarantee, warranty or representation about this information. Any projections, opinions, assumptions or estimates used here are for example only and do not represent the current or future performance of the property. Interested parties should conduct an independent investigation to determine whether the property suits their needs. REV 11/25