

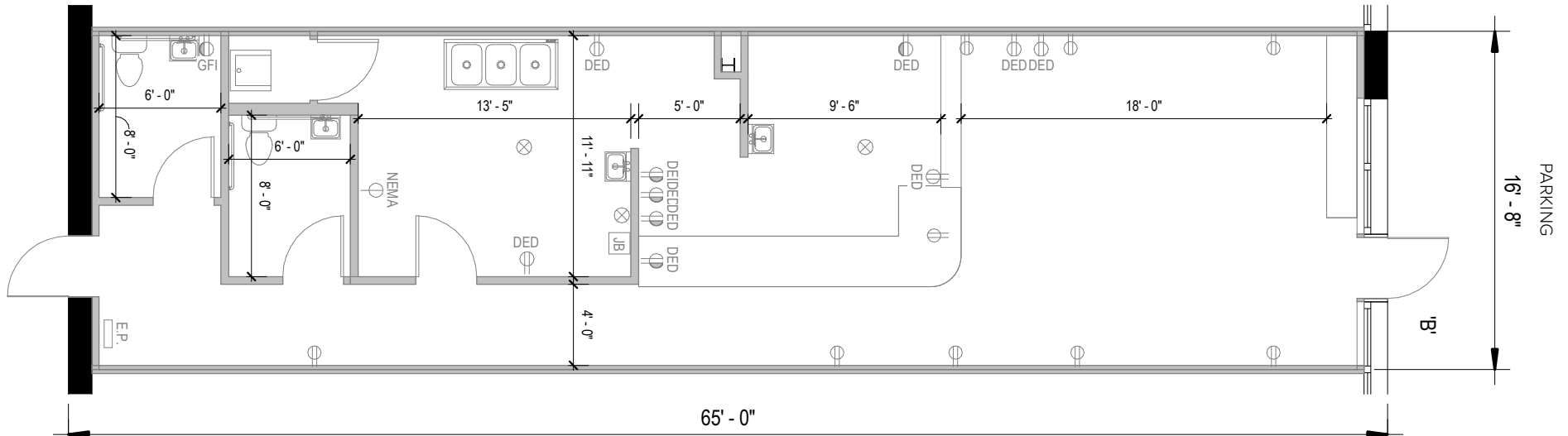

Total SF Available:
 1,199 SF

Retail shell space

Note: This space plan is subject to existing field conditions. This drawing is proprietary and the exclusive property of St. John Properties, Inc. Any duplications, distribution, or other unauthorized use is strictly prohibited.





Retail at Windsor Corporate Park

6860 & 6900 Dogwood Road
Windsor Mill, MD 21244

6860 Dogwood Road		
Suite A	Buongiorno Restaurant	1,733 SF
Suite B	AVAILABLE	1,090 SF
Suite C	Lake Trout	1,754 SF
Suites D-E	Pro Nails & Skincare	1,952 SF
Suite F	Top Tier Beauty Palace	1,583 SF
6900 Dogwood Road		
Suite A	Subway	1,580 SF
Suite B	AVAILABLE	1,199 SF
Suite C	Alexander's Barber Shop & Salon	1,211 SF
Suite D	Dogwood Liquors	1,906 SF
Suite F	Dunkin'/Baskin Robbins	2,229 SF

Traffic Count (MDOT)

Dogwood Rd at Lord Baltimore Dr: 12,062 vehicles/day

Demographics

	1 Mile	3 Miles	5 Miles
Population	12,774	108,847	323,098
Avg. Household Income	\$101,243	\$95,232	\$100,399





Contact Us

For additional leasing information or to schedule a tour, contact:

Eric Llewellyn
Senior Retail Leasing Representative
ellewellyn@sjpi.com | 443.464.1308

Bill Holzman
Vice President, Retail Leasing
bholzman@sjpi.com | 410.369.1240



This information contained in this publication has been obtained from sources believed to be reliable. St. John Properties makes no guarantee, warranty or representation about this information. Any projections, opinions, assumptions or estimates used here are for example only and do not represent the current or future performance of the property. Interested parties should conduct an independent investigation to determine whether the property suits their needs. REV 1/25