

**Glen Burnie Crossing**  
87 Dover Road | Glen Burnie, MD 21060  
Suites A-B

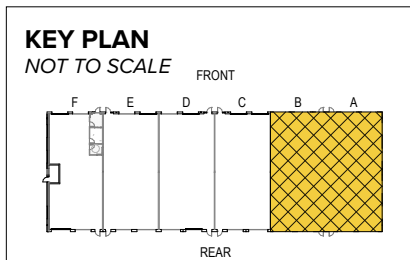

**Total SF Available:**  
5,250 SF

5,250 sq. ft. end unit with drive-through design. 642 sq. ft. of existing office and waiting room space, 12'x12' drive-in doors (2), and 10'Wx12' drive-in doors (6)



**Note:** This space plan is subject to existing field conditions. This drawing is proprietary and the exclusive property of St. John Properties, Inc. Any duplications, distribution, or other unauthorized use is strictly prohibited.

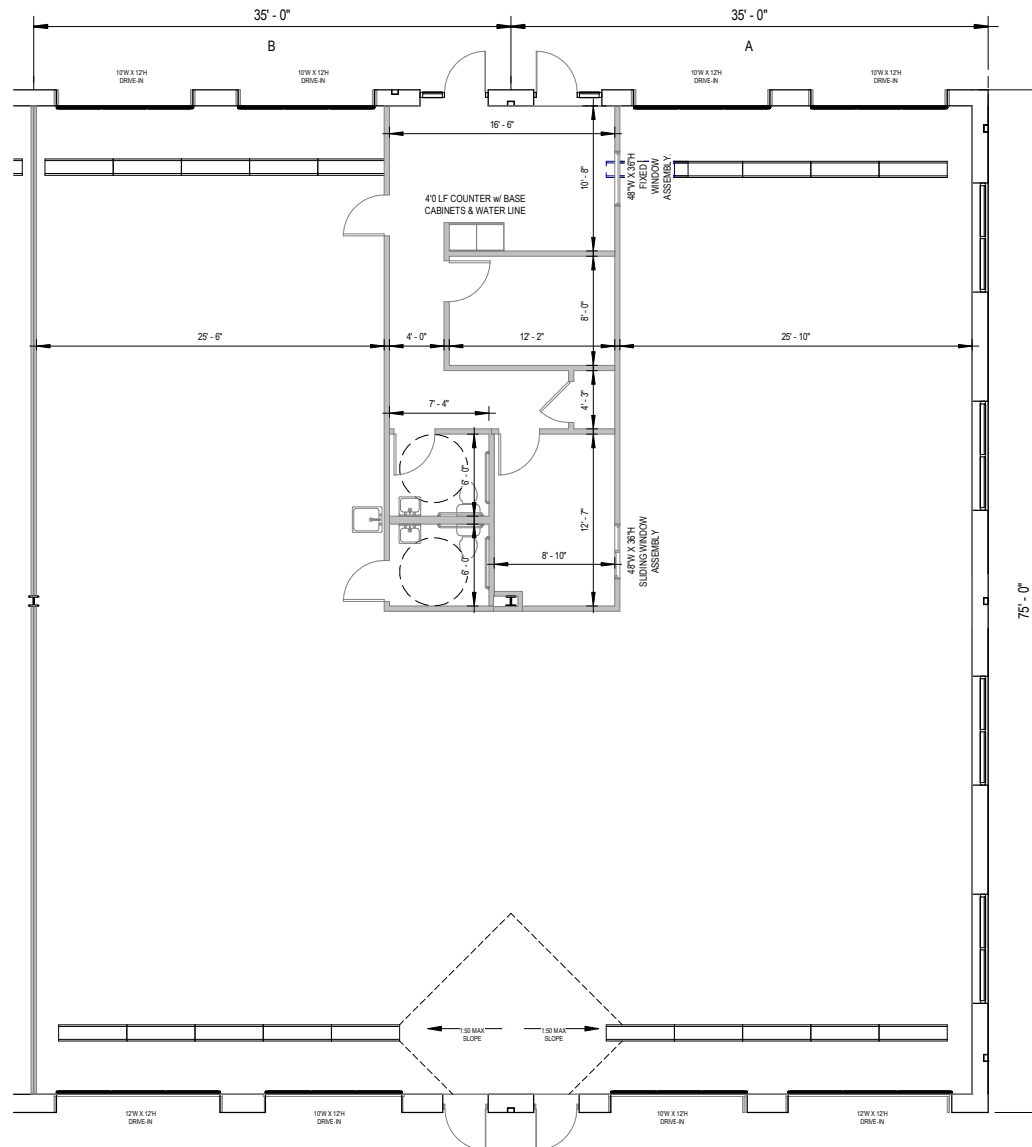





# Glen Burnie Crossing

## SITE PLAN

### Automotive/Retail Buildings

|               |           |
|---------------|-----------|
| 79 Dover Road | 13,725 SF |
| 87 Dover Road | 15,750 SF |
| 89 Dover Road | 15,750 SF |
| 91 Dover Road | 13,125 SF |
| 93 Dover Road | 13,125 SF |

### Automotive/Retail Specifications

|                |                        |
|----------------|------------------------|
| Suite Sizes    | 2,625 up to 15,750 SF  |
| Ceiling Height | 16.5 ft. clear minimum |
| Parking        | 4 spaces per 1,000 SF  |
| Heat           | Gas                    |
| Roof           | TPO                    |
| Construction   | Brick on block         |
| Loading        | Drive-through          |
| Zoning         | C-4                    |

### Flex/Retail Buildings

|               |           |               |
|---------------|-----------|---------------|
| 77 Dover Road | 31,320 SF | LEED DESIGNED |
| 81 Dover Road | 20,000 SF | LEED DESIGNED |

### Flex/Retail Specifications

|                |                        |
|----------------|------------------------|
| Suite Sizes    | Up to 31,320 SF        |
| Ceiling Height | 16.5 ft. clear minimum |
| Parking        | 4 spaces per 1,000 SF  |
| Heat           | Gas                    |
| Roof           | TPO                    |
| Construction   | Brick on block         |
| Loading        | Drive-in               |
| Zoning         | C-4                    |

### Flex/R&D Building

|               |           |
|---------------|-----------|
| 85 Dover Road | 35,100 SF |
|---------------|-----------|

### Flex/R&D Specifications

|                |                        |
|----------------|------------------------|
| Suite Sizes    | Up to 35,100 SF        |
| Ceiling Height | 16.5 ft. clear minimum |
| Parking        | 4 spaces per 1,000 SF  |
| Heat           | Gas                    |
| Roof           | TPO                    |
| Construction   | Brick on block         |
| Loading        | Drive-in               |
| Zoning         | C-4                    |



Scan with your mobile device to take a virtual tour, download floor plans and more!

# Contact Us

For additional information or to schedule a tour, contact:

## FLEX/AUTOMOTIVE SPACE:

**Claire Cobert**

Leasing Representative

ccobert@sjpi.com | 410.369.1274

## RETAIL SPACE:

**Bill Holzman**

Vice President, Retail Leasing

bholzman@sjpi.com | 410.369.1240

**Eric Llewellyn**

Senior Retail Leasing Representative

ellewellyn@sjpi.com | 443.464.1308

## Corporate Headquarters:

2560 Lord Baltimore Drive, Baltimore, MD 21244

**410.788.0100 | SJPI.COM**

## About St. John Properties

St. John Properties, Inc. is one of the nation's largest and most successful privately held commercial real estate firms. Founded in 1971, the vertically-integrated company develops, owns and manages office, flex/research and development, warehouse, retail and residential space.

Connect with us @stjohnprop



*This information contained in this publication has been obtained from sources believed to be reliable. St. John Properties makes no guarantee, warranty or representation about this information. Any projections, opinions, assumptions or estimates used here are for example only and do not represent the current or future performance of the property. Interested parties should conduct an independent investigation to determine whether the property suits their needs. REV 08/24*