

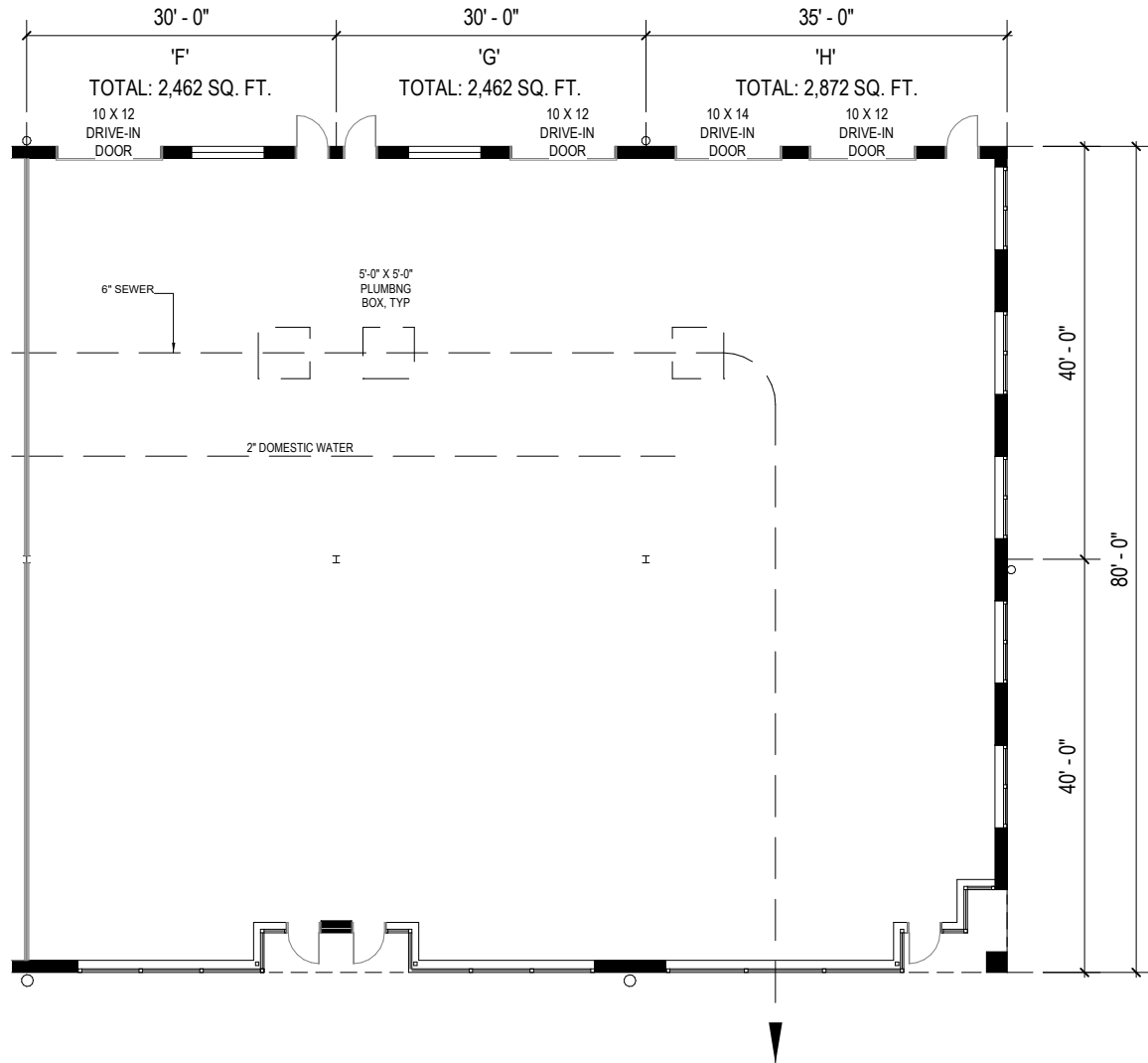

**Total SF Available:**  
7,796 SF

100% warehouse space,  
drive-in doors (3), 10'x14'  
drive-in door (1)

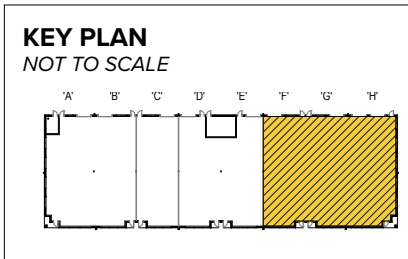

**Note:** This space plan is subject to existing field conditions. This drawing is proprietary and the exclusive property of St. John Properties, Inc. Any duplications, distribution, or other unauthorized use is strictly prohibited.



# Glen Burnie Crossing

## SITE PLAN

### Automotive/Retail Buildings

79 Dover Road	13,725 SF
87 Dover Road	15,750 SF
89 Dover Road	15,750 SF
91 Dover Road	13,125 SF
93 Dover Road	13,125 SF

### Automotive/Retail Specifications

Suite Sizes	2,625 up to 15,750 SF
Ceiling Height	16.5 ft. clear minimum
Parking	4 spaces per 1,000 SF
Heat	Gas
Roof	TPO
Construction	Brick on block
Loading	Drive-through
Zoning	C-4

### Flex/Retail Buildings

77 Dover Road	31,320 SF	LEED DESIGNED
81 Dover Road	20,000 SF	LEED DESIGNED

### Flex/Retail Specifications

Suite Sizes	Up to 31,320 SF
Ceiling Height	16.5 ft. clear minimum
Parking	4 spaces per 1,000 SF
Heat	Gas
Roof	TPO
Construction	Brick on block
Loading	Drive-in
Zoning	C-4

### Flex/R&D Building

85 Dover Road	35,100 SF
---------------	-----------

### Flex/R&D Specifications

Suite Sizes	Up to 35,100 SF
Ceiling Height	16.5 ft. clear minimum
Parking	4 spaces per 1,000 SF
Heat	Gas
Roof	TPO
Construction	Brick on block
Loading	Drive-in
Zoning	C-4



# Contact Us

For additional information or to schedule a tour, contact:

## FLEX/AUTOMOTIVE SPACE:

**Claire Cobert**

Leasing Representative

ccobert@sjpi.com | 410.369.1274

## RETAIL SPACE:

**Bill Holzman**

Vice President, Retail Leasing

bholzman@sjpi.com | 410.369.1240

**Eric Llewellyn**

Retail Leasing Representative

ellewellyn@sjpi.com | 443.464.1308

## Corporate Headquarters:

2560 Lord Baltimore Drive, Baltimore, MD 21244

**410.788.0100 | SJPI.COM**

## About St. John Properties

St. John Properties, Inc. is one of the nation's largest and most successful privately held commercial real estate firms. Founded in 1971, the vertically-integrated company develops, owns and manages office, flex/research and development, warehouse, retail and residential space nationwide.

Connect with us @stjohnprop



*This information contained in this publication has been obtained from sources believed to be reliable. St. John Properties makes no guarantee, warranty or representation about this information. Any projections, opinions, assumptions or estimates used here are for example only and do not represent the current or future performance of the property. Interested parties should conduct an independent investigation to determine whether the property suits their needs. REV 02/23*