



410.788.0100 | SJPI.COM

WINDSOR OFFICE PARK

7265 Windsor Boulevard | Windsor Mill, MD 21244

Suites 122-124



TOTAL SF AVAILABLE:
5,674 SF

Nicely built out and furnished office with large conference room, several meeting/breakout rooms, private offices, and large sit-down break area

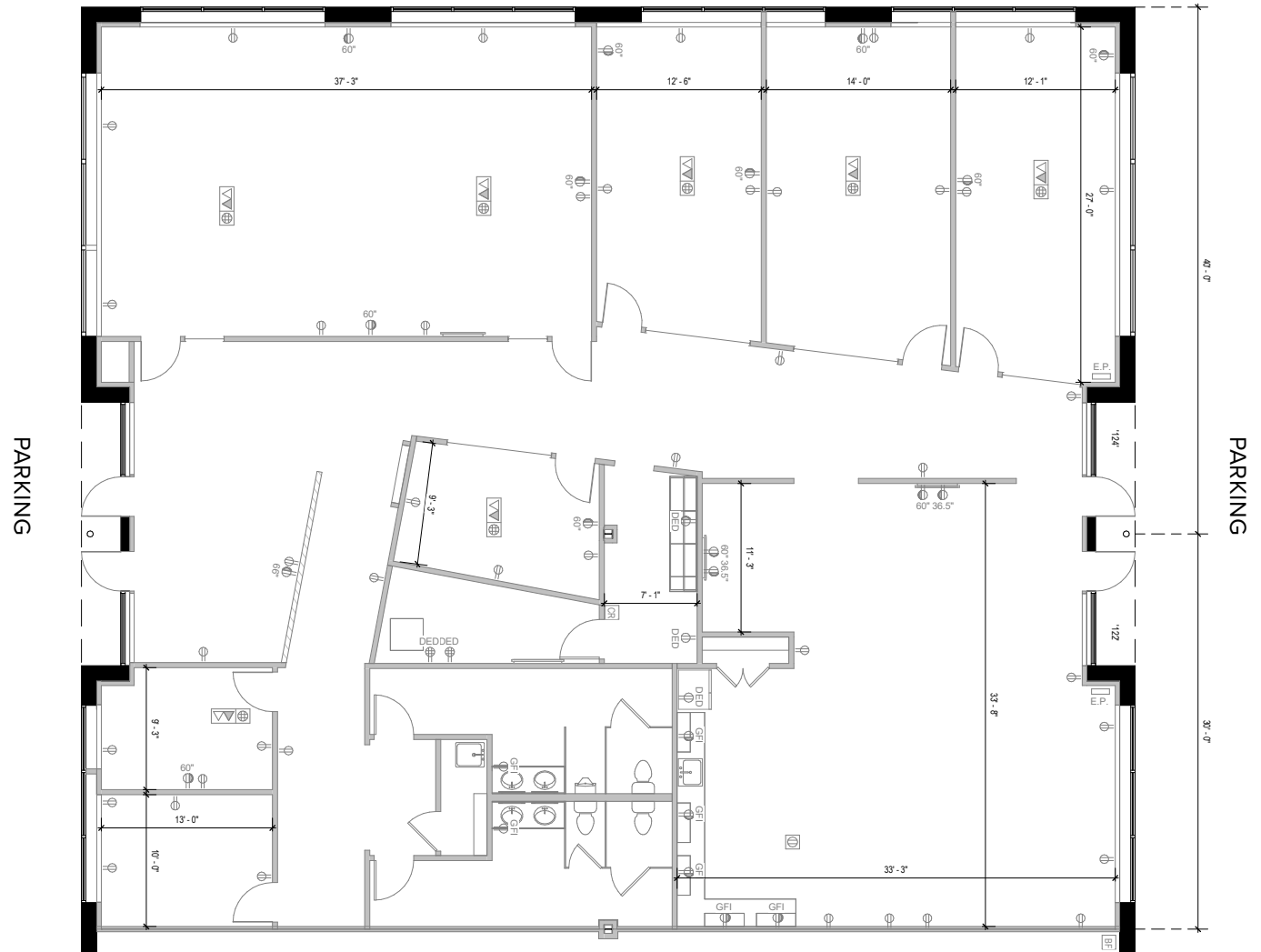
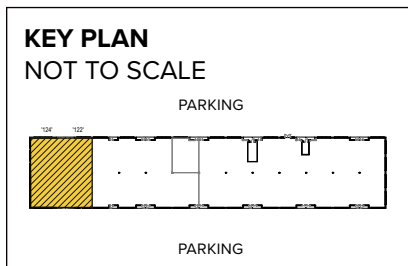

Note: This space plan is subject to existing field conditions. This drawing is proprietary and the exclusive property of St. John Properties, Inc. Any duplications, distribution, or other unauthorized use is strictly prohibited.

About Windsor Office Park

Windsor Office Park is a 10-acre business community located at the intersection of North Rolling Road and Windsor Boulevard in Baltimore County, just five minutes from the Baltimore Beltway (I-695).

The unified architecture of St. John Properties' two office buildings, comprising 63,200 square feet of space, and two retail buildings offering more than 15,000 square feet of space, provides Windsor Office Park a campus-like business environment.

Tenant sizes from 2,400 square feet to 32,000 square feet of space offer businesses straight-forward, economical and high-utility space in a covenant-protected and well-maintained atmosphere. Ample glass lines enable natural lighting, and free, generous parking is available adjacent to the single-story office and retail buildings.

Single-Story Office Buildings

7265 Windsor Boulevard	32,000 SF
------------------------	-----------

7275 Windsor Boulevard	31,200 SF
------------------------	-----------

Single-Story Office Specifications

Suite Sizes	2,400 up to 32,000 SF
-------------	-----------------------

Ceiling Height	10 ft. clear minimum
----------------	----------------------

Parking	5 spaces per 1,000 SF
---------	-----------------------

HVAC	Gas
------	-----

Roof	EPDM rubber
------	-------------

Construction	Brick on block
--------------	----------------

Zoning	ML-IM
--------	-------

Retail Buildings

2835 N. Rolling Road	9,425 SF
----------------------	----------

Wawa	5,940 SF
------	----------



For more information on Windsor Office Park visit: sjpi.com/windsoroffice



Distances to:

Baltimore, MD (Downtown)	9 miles
BWI Airport	11 miles
Columbia, MD	10 miles
Interstate 70	4 miles
Interstate 83	9 miles
Interstate 95	7 miles
Interstate 695 (Baltimore Beltway)	2 miles
Owings Mills, MD	5 miles
Towson, MD	8 miles

Contact Us

For additional leasing information or to schedule a tour, contact:

Claire Cobert

Leasing Representative

ccobert@sjpi.com | 410.369.1274

Corporate Headquarters:

2560 Lord Baltimore Drive | Baltimore, MD 21244

410.788.0100 | SJPI.COM



Scan with your mobile device to take a virtual tour, download floor plans and more!

About St. John Properties

St. John Properties, Inc. is one of the nation's largest and most successful privately held commercial real estate firms. Founded in 1971, the vertically-integrated company develops, owns and manages office, flex/research and development, warehouse, retail and residential space nationwide.

Connect with us @stjohnprop



This information contained in this publication has been obtained from sources believed to be reliable. St. John Properties makes no guarantee, warranty or representation about this information. Any projections, opinions, assumptions or estimates used here are for example only and do not represent the current or future performance of the property. Interested parties should conduct an independent investigation to determine whether the property suits their needs. REV 11/23