

MAGOTHY BEACH PLAZA
33 Magothy Beach Road | Pasadena, MD 21122
Suites 100-101



TOTAL SF AVAILABLE:
2,282 SF

*Second generation restaurant,
equipment in place*

Note: This space plan is subject to existing field conditions. This drawing is proprietary and the exclusive property of St. John Properties, inc. Any duplications, distribution, or other unauthorized use is strictly prohibited.

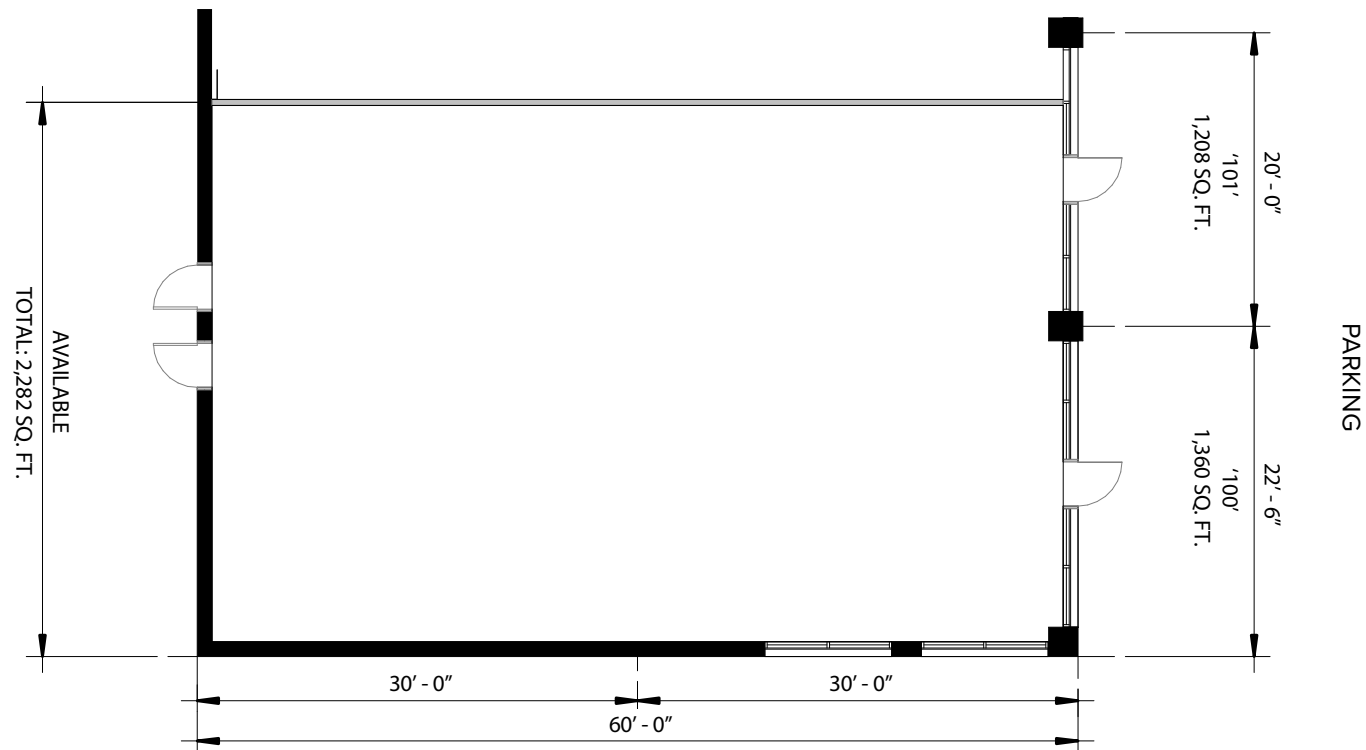

About Magothy Beach Plaza

- ▶ Prime retail space facing Route 100 at busy intersection with Magothy Beach Road.
- ▶ Up to 1,311 square feet available now!
- ▶ Join Ledo's Pizza, Tower Federal Credit Union, Mutiny Pirate Bar, Pivot Physical Therapy and more!
- ▶ Adjacent to Lakeshore Plaza, a 143,550 square foot neighborhood retail center.



25 Magothy Beach Road

Suite 101	Tower Federal Credit Union	2,100 SF
Suite 102-103	Pasadena Eyecare	2,423 SF
Suite 104	Edward Jones	1,214 SF
Suites 105-107	Passion Asian Bistro	3,563 SF

31 Magothy Beach Road

Suites 101 - 102	Purity Nail Spa	2,869 SF
Suite 103	AVAILABLE	1,311 SF
Suites 104-105	Pivot Physical Therapy	2,948 SF
Suites 106-107	Ledo's Pizza	2,308 SF

33 Magothy Beach Road

Suites 100-101	AVAILABLE	2,282 SF
Suites 102-103	Wise Care Urgent Care	2,702 SF
Suite 104	AVAILABLE	1,208 SF
Suites 105-107	Sherwin Williams	3,708 SF

Traffic count (MDOT)

MD Rt. 100 at Mountain Road: 26,221 vehicles per day

Demographics

	1 Mile	3 Miles	5 Miles
Population	6,687	58,644	130,540
Avg. Household Income	\$118,298	\$142,555	\$149,116



For more information on Magothy Beach Plaza, visit: sjpi.com/magothybeach



Distances to:

Annapolis, MD (Downtown)	14 miles
Baltimore, MD (Downtown)	17 miles
BWI Airport	14 miles
Interstate 95	17 miles
Interstate 97	8.5 miles
Interstate 695 (Baltimore Beltway)	8 miles
Washington, D.C. (Downtown)	41 miles



Scan with your mobile device to take a virtual tour, download floor plans and more!

Contact Us

For additional leasing information or to schedule a tour, contact:

Eric Llewellyn

Retail Leasing
Representative

ellewellyn@sjpi.com
443.464.1308

Bill Holzman

Vice President,
Retail Leasing

bholzman@sjpi.com
410.369.1240

Corporate Headquarters:

2560 Lord Baltimore Drive, Baltimore, MD 21244

410.788.0100 | SJPI.COM

About St. John Properties

St. John Properties, Inc. is one of the nation's largest and most successful privately held commercial real estate firms. Founded in 1971, the vertically-integrated company develops, owns and manages office, flex/ research and development, warehouse, retail and residential space nationwide.

Connect with us @stjohnprop



This information contained in this publication has been obtained from sources believed to be reliable. St. John Properties makes no guarantee, warranty or representation about this information. Any projections, opinions, assumptions or estimates used here are for example only and do not represent the current or future performance of the property. Interested parties should conduct an independent investigation to determine whether the property suits their needs. REV 1/24