

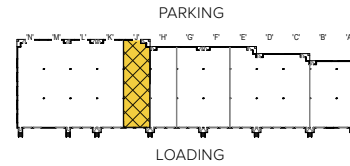

Total SF Available:
3,000 SF

*315 sq. ft. of existing office
with dock doors (2)*

KEY PLAN
NOT TO SCALE



Note: This space plan is subject to existing field conditions. This drawing is proprietary and the exclusive property of St. John Properties, Inc. Any duplications, distribution, or other unauthorized use is strictly prohibited.

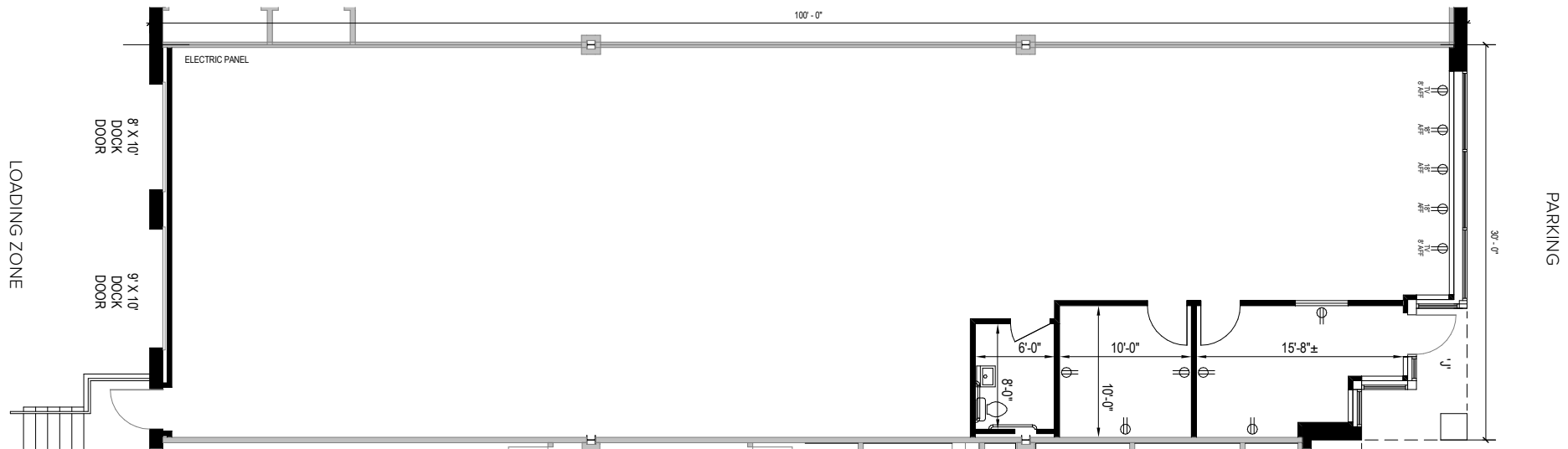

About Troy Hill Corporate Center

Troy Hill Corporate Center is a 15-acre project of St. John Properties, Inc. The business community, contained within Troy Hill Commerce Center, is located on US Route 1, near MD Route 100, Interstate 95, and MD Route 295 just minutes from Baltimore-Washington International Airport.

The unified architecture of Troy Hill Corporate Center's four buildings, comprising 150,000 square feet of office and R&D/flex space, provides the Center a campus-like business environment. Tenant sizes from 2,280 square feet to 39,120 square feet offer businesses straight-forward, economical and high-utility space in a covenant-protected, well-maintained atmosphere. Thirty foot wide spaces combined with 16 foot high ceiling heights offer maximum flexibility. Free, generous parking is available adjacent to the building.

Nearby St. John Properties business parks (Arundel Overlook, BWI Commerce Park, BWI Technology Park, Cromwell Business Park, International Trade Center and Rt. 100 Tech Park) contain nearly 2.2 million square feet of R&D/flex and office space in close proximity to Troy Hill.

Flex/R&D Space

7020 Troy Hill Drive	39,120 SF
7024 Troy Hill Drive	35,640 SF
7180 Troy Hill Drive	39,120 SF
7184 Troy Hill Drive	36,120 SF

Flex/R&D Specifications

Suite Sizes	2,280 up to 39,120 SF
Ceiling Height	16 ft. clear minimum
Offices	Built to suit
Parking	4 spaces per 1,000 SF
Heat	Gas
Roof	EPDM rubber
Exterior Walls	Brick on block
Loading	Dock or drive-in
Zoning	M-1

For more information on Troy Hill Corporate Center, visit: sjpi.com/troyhill

Pictured Right: Rear dock loading at 7024 Troy Hill Drive

Pictured Bottom: Troy Hill Corporate Center campus





Google Imagery ©2021 Google, Imagery ©2021 Commonwealth of Virginia, Maxar Technologies, U.S. Geological Survey, USDA Farm Service Agency, Map data ©2021

Distances to:

Annapolis, MD (Downtown)	25 miles
Baltimore, MD (Downtown)	10 miles
BWI Airport	6 miles
Columbia, MD	7 miles
Interstate 95	2 miles
Interstate 495	18 miles
Interstate 695	6 miles
MD Route 295	3 miles
Washington, D.C.	30 miles



Scan with your mobile device to take a virtual tour, download floor plans and more!

Contact Us

For additional leasing information or to schedule a tour, contact:

Bill Jautze
 Assistant Vice President, Leasing
 bjautze@sjpi.com | 410.369.1213

Corporate Headquarters:
 2560 Lord Baltimore Drive | Baltimore, MD 21244

410.788.0100 | SJPI.COM

About St. John Properties
 St. John Properties, Inc. is one of the nation's largest and most successful privately held commercial real estate firms. The company owns, manages, and has developed office, flex/research and development, warehouse, retail, and residential space nationwide.

Connect with us @stjohnprop



This information contained in this publication has been obtained from sources believed to be reliable. St. John Properties makes no guarantee, warranty or representation about this information. Any projections, opinions, assumptions or estimates used here are for example only and do not represent the current or future performance of the property. Interested parties should conduct an independent investigation to determine whether the property suits their needs. REV 07/23