

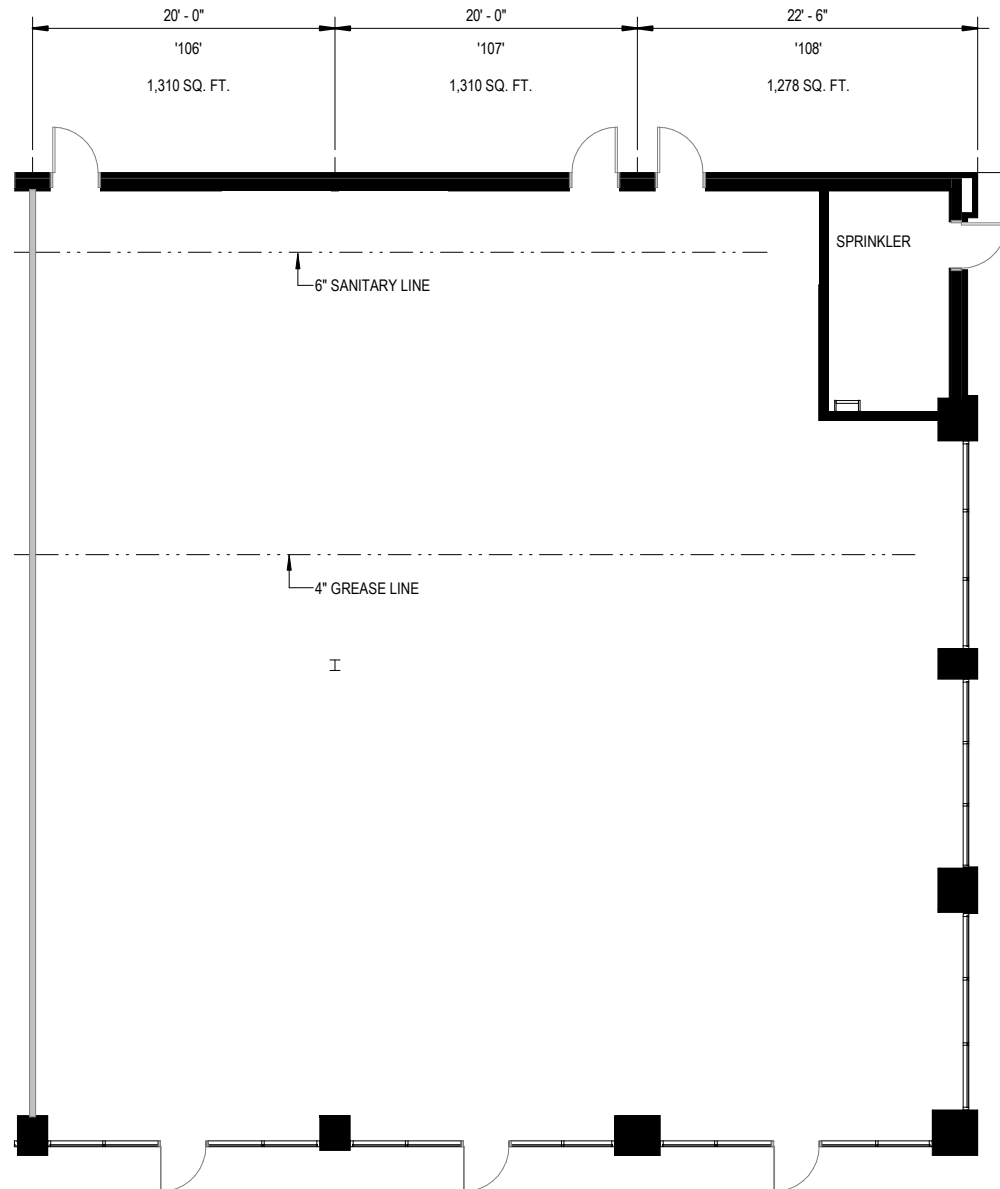

**Total SF Available:**  
1,278 - 3,898 SF

*New inline retail*

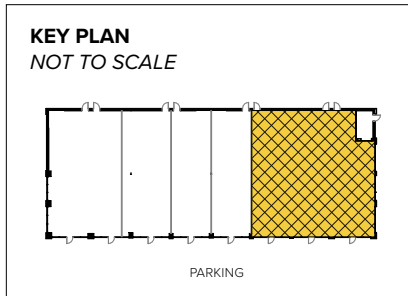

**Note:** This space plan is subject to existing field conditions. This drawing is proprietary and the exclusive property of St. John Properties, Inc. Any duplications, distribution, or other unauthorized use is strictly prohibited.



910 Cromwell Park Drive

# Retail

## Inline retail & pad sites

- ▶ Prime access and LED signage visible to 121,110 vehicles per day along Interstate 97
- ▶ Great spot for quick-service restaurants
- ▶ 165-acre business community located directly off Interstate 97 between Baltimore and Annapolis
- ▶ Adjacent to BWI Thurgood Marshall Airport
- ▶ Easy access to Interstates 97, 95, 895 & MD Routes 295, 100, and 176

### Traffic Count (MDOT)

Aviation Boulevard:	23,250 vehicles/day
Cromwell Park Drive at Aviation Boulevard:	13,711 vehicles/day
I-97 (Electronic Sign):	121,110 vehicles/day

### Demographics

	1 Mile	3 Miles	5 Miles
Population	5,721	88,953	209,684
Avg. Household Income	\$119,611	\$108,068	\$116,888

**Inline & Pad Sites Available:** *Join Starbucks, Subway, Royal Farms, Chipotle & more!*

### 910 Cromwell Park Drive

Suites 101–102	Starbucks	2,687 SF
Suite 103	Gibson Schuler	1,631 SF
Suites	WildFlower + Petal Pusher	3,638 SF
Suite 107	<b>AVAILABLE</b>	1,317 SF
Suite 108	Berkshire Hathaway	1,483 SF

### 920 Cromwell Park Drive

Suites 101-102	Chipotle   <i>COMING SOON</i>	2,458 SF
Suite 103	Charleys   <i>COMING SOON</i>	1,614 SF
Suite 104	TropQ Pizza   <i>COMING SOON</i>	1,310 SF
Suite 105	Hibachi Express   <i>COMING SOON</i>	1,310 SF
Suites 106-108	<b>AVAILABLE</b>	3,898 SF

### 930 Cromwell Park Drive

Royal Farms

### 6930 Aviation Boulevard

7-Eleven	2,940 SF
----------	----------

### 6934 Aviation Boulevard

Suite A	<b>AVAILABLE</b>	3,150 SF
Suite B	<b>AVAILABLE</b>	3,750 SF

### 6938 Aviation Boulevard

Suites A–C	Los Portales	4,875 SF
Suite D	Aviation Deli & Grill	1,625 SF
Suite E	Subway	1,625 SF

### 891 Cromwell Park Drive

Suites 101-106	<b>AVAILABLE</b>	8,125 SF
----------------	------------------	----------

### 901 Cromwell Park Drive

Suites 101-110	<b>AVAILABLE</b>	12,772 SF
----------------	------------------	-----------

### Pad Site

Pad Site A	1.0 Acre
------------	----------

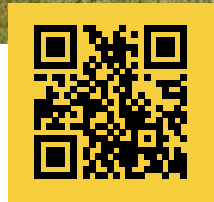

Scan with your mobile device to take a virtual tour, download floor plans and more!

# Contact Us

For additional information or to schedule a tour, contact:

### FLEX/R&D AND OFFICE SPACE:

**DJ Andrew**  
Partner in Training  
dandrew@sjpi.com  
410.369.1222

**Lacey Johansson**  
Assistant Vice President, Leasing  
ljohansson@sjpi.com  
410.369.1229

### RETAIL SPACE:

**Eric Llewellyn**  
Retail Leasing Representative  
ellewellyn@sjpi.com  
443.464.1308

**Bill Holzman**  
Vice President, Retail Leasing  
bholzman@sjpi.com  
410.369.1240

**Corporate Headquarters:**  
2560 Lord Baltimore Drive, Baltimore, MD 21244  
**410.788.0100 | SJPI.COM**

### About St. John Properties

St. John Properties, Inc. is one of the nation's largest and most successful privately held commercial real estate firms. Founded in 1971, the vertically-integrated company develops, owns and manages office, flex/research and development, warehouse, retail and residential space nationwide.

Connect with us @stjohnprop



*This information contained in this publication has been obtained from sources believed to be reliable. St. John Properties makes no guarantee, warranty or representation about this information. Any projections, opinions, assumptions or estimates used here are for example only and do not represent the current or future performance of the property. Interested parties should conduct an independent investigation to determine whether the property suits their needs. REV 10/23*