

**Total SF Available:**  
3,654 SF

*Note: This space plan is subject to existing field conditions. This drawing is proprietary and the exclusive property of St. John Properties, Inc. Any duplications, distribution, or other unauthorized use is strictly prohibited.*

*Inline retail with high visibility*

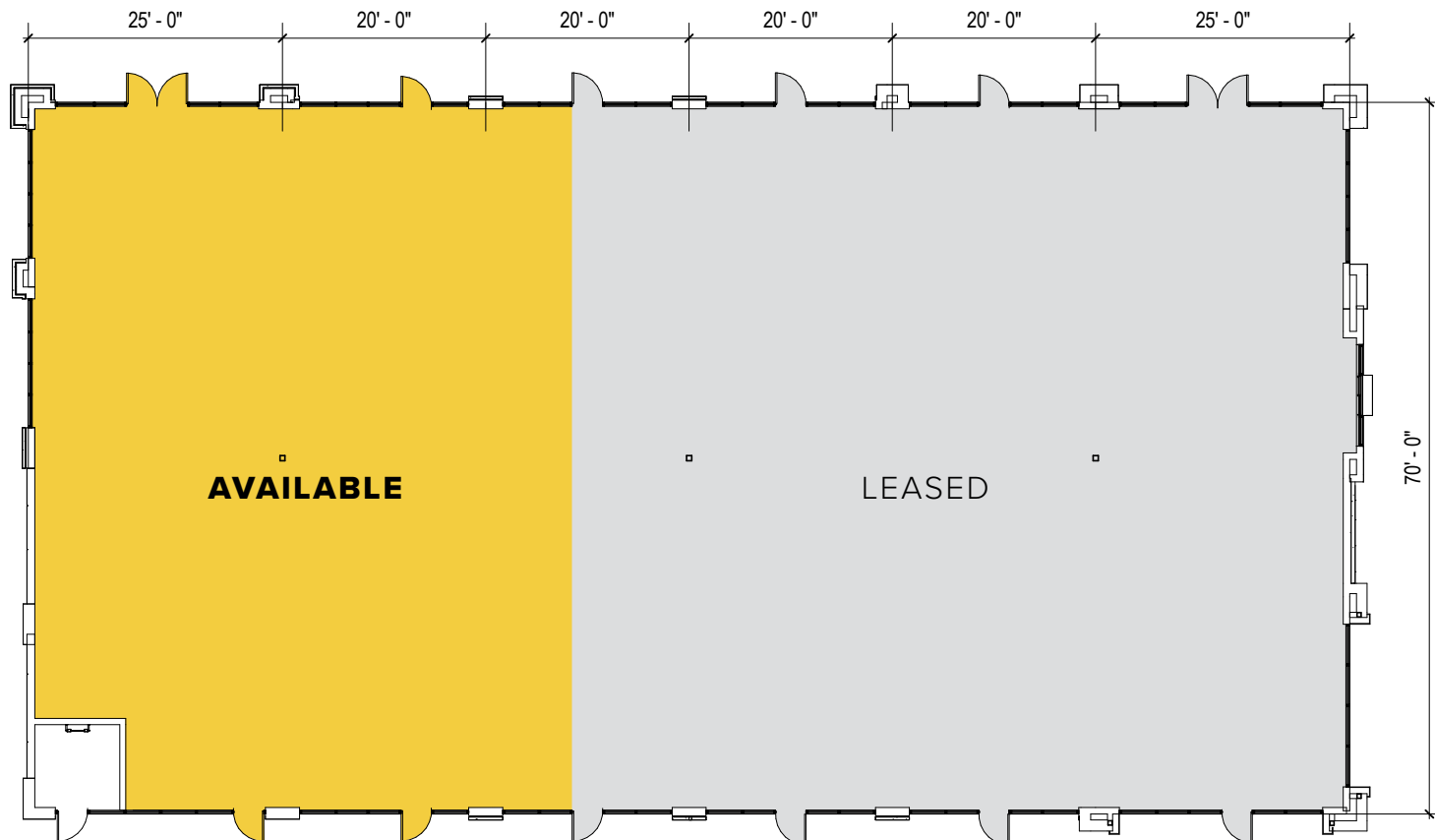



*Join Wok The Line, The Village Baker, Starbucks, Jersey Mike's Subs, Gloss Salon, Verizon Wireless, & more!*

# Inline Retail

Offering drive-thrus & patio seating

Demographics			
	1 Mile	3 Miles	5 Miles
Population	7,264	61,126	153,817
Avg. Household Income	\$79,953	\$98,766	\$103,753
Traffic Counts			
North County Blvd (W 700 N): 30,000+ vehicles/day			
Pleasant Grove Blvd: 60,000+ vehicles/day			
Interstate 15: 225,000+ vehicles/day			

Retail Buildings		
875 S North County Blvd	9,675 SF	
1043 S Valley Grove Way	9,725 SF	
1051 S Valley Grove Way	9,377 SF	
1865 W Pleasant Grove Blvd	11,152 SF	
1882 W Pleasant Grove Blvd	10,396 SF	
1926 W Pleasant Grove Blvd	10,477 SF	
863 S North County Blvd	9,031 SF	
887 S North County Blvd	9,031 SF	
758 S North County Blvd	13,050 SF	
Retail L	10,000 SF	FUTURE
Retail M	10,500 SF	FUTURE





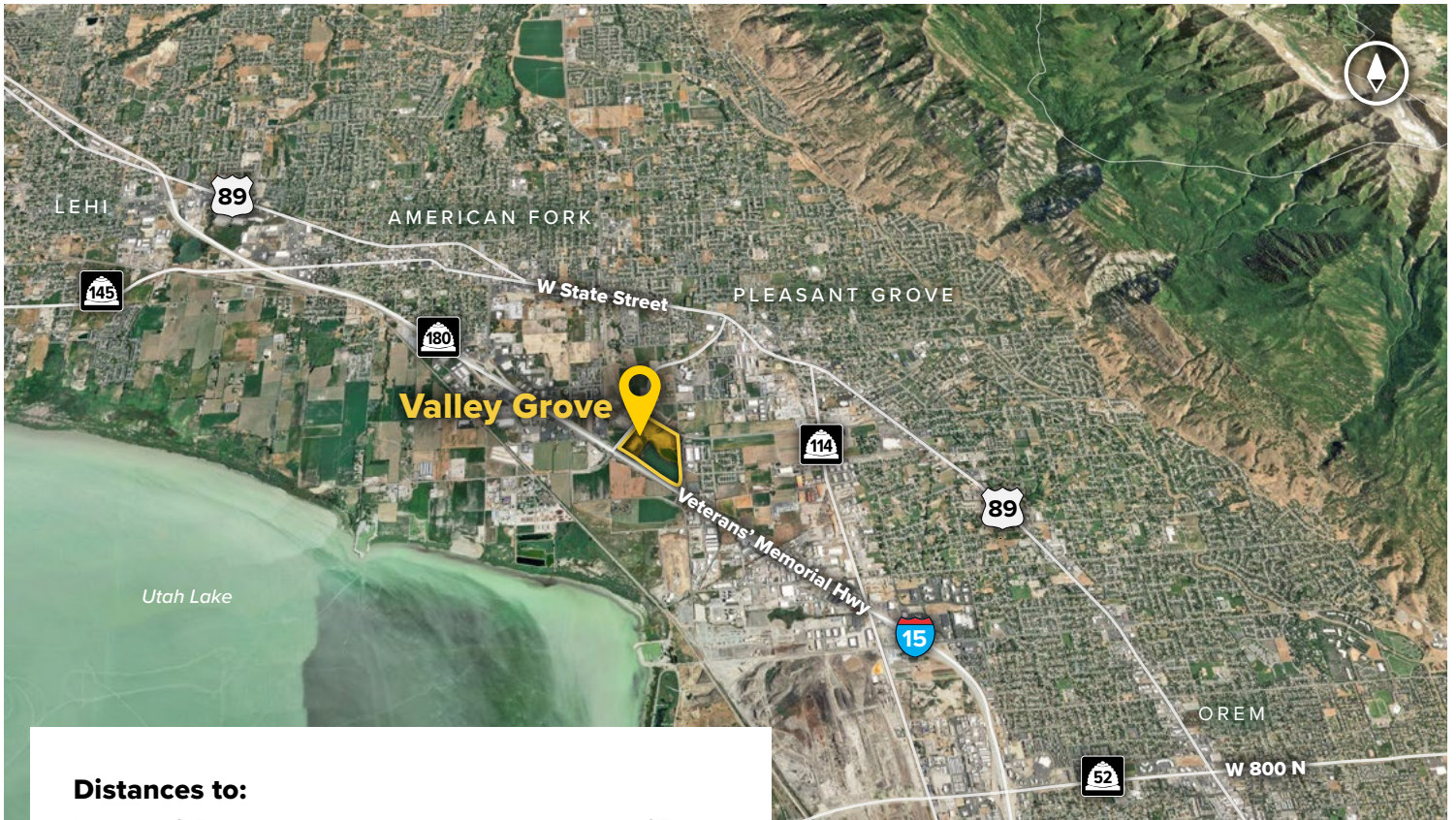

#### Distances to:

Interstate 215 .....	25 miles
Provo, UT (Downtown) .....	12 miles
Salt Lake City, UT (Downtown) .....	34.5 miles
Salt Lake City International Airport .....	38 miles



Scan now to take a virtual tour, download floor plans and more!

## Contact Us

For additional leasing information or to schedule a tour, contact:

#### Scott Gifford

Director of Leasing

sgifford@sjpi.com

801.899.7991

#### Daniel Thomas

Regional Partner, Utah

dthomas@sjpi.com

801.899.7991

#### Utah Office:

1064 S North County Boulevard | Suite 190  
Pleasant Grove, Utah 84062

**801.899.7991 | SJPI.COM/UTAH**



MD • CO • FL • LA • NC • NV • PA • TX • UT • VA • WI



#### About St. John Properties

St. John Properties Utah owns and is developing more than 1.9 million square feet of commercial space across five business communities in Salt Lake, Weber, and Utah Counties.

St. John Properties, Inc. is one of the nation's largest and most successful privately held commercial real estate firms. Founded in 1971, the vertically-integrated company develops, owns and manages office, flex/research and development, warehouse, retail and residential space nationwide.

Connect with us @stjohnprop



This information contained in this publication has been obtained from sources believed to be reliable. St. John Properties makes no guarantee, warranty or representation about this information. Any projections, opinions, assumptions or estimates used here are for example only and do not represent the current or future performance of the property. Interested parties should conduct an independent investigation to determine whether the property suits their needs. REV 1/24