

**Total SF Available:**  
1,400 - 9,031 SF

*Note: This space plan is subject to existing field conditions. This drawing is proprietary and the exclusive property of St. John Properties, Inc. Any duplications, distribution, or other unauthorized use is strictly prohibited.*

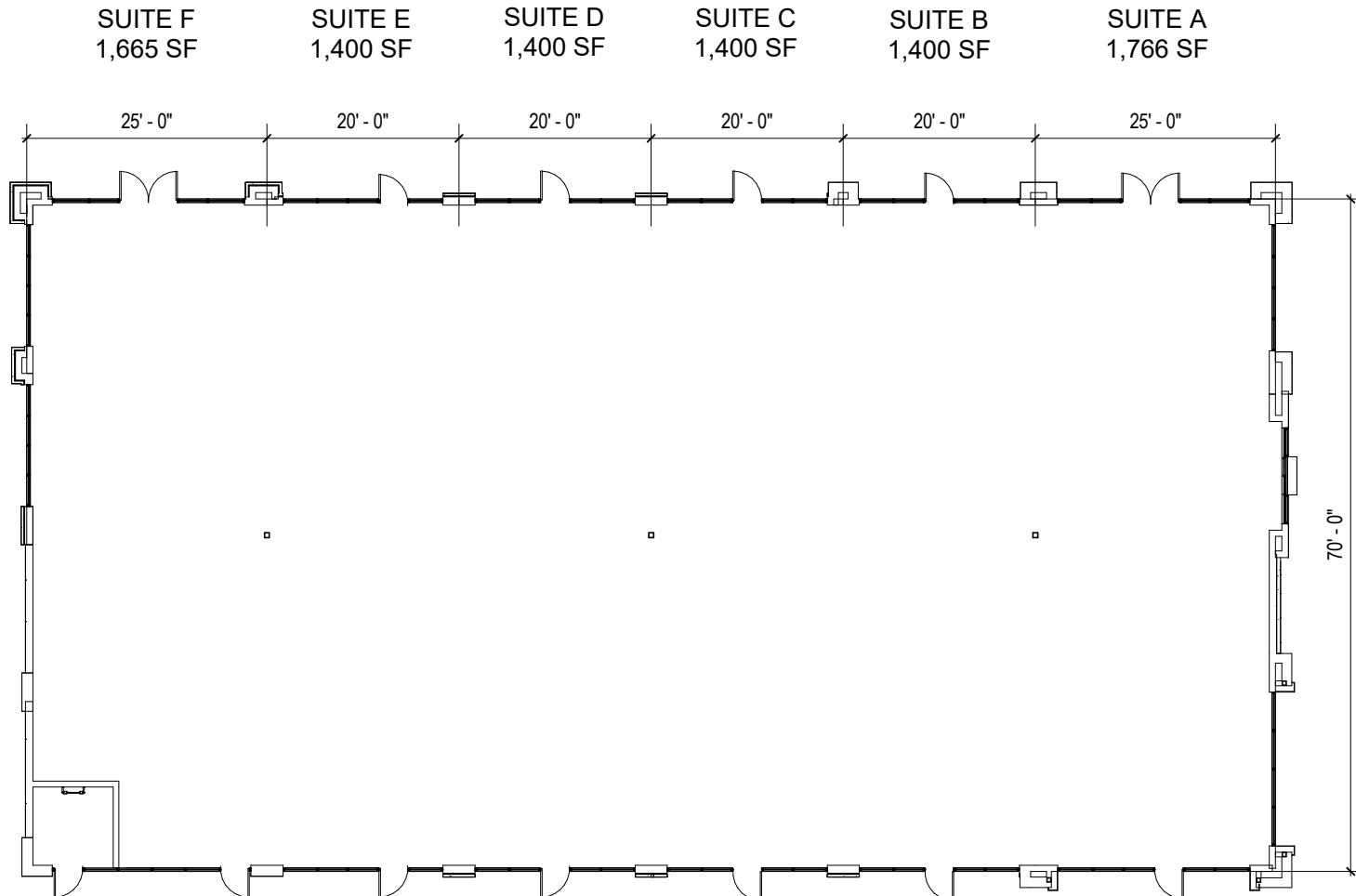



**Join Wok The Line, The Village Baker, Starbucks, Jersey Mike's Subs, Gloss Salon, Verizon Wireless, & more!**

# Inline Retail

Offering drive-thrus & patio seating

### Demographics

	1 Mile	3 Miles	5 Miles
Population	7,264	61,126	153,817
Avg. Household Income	\$79,953	\$98,766	\$103,753

### Traffic Counts

North County Blvd (W 700 N):	30,000+ vehicles/day
Pleasant Grove Blvd:	60,000+ vehicles/day
Interstate 15:	225,000+ vehicles/day

### Retail Buildings

875 S North County Blvd	10,000 SF	
1043 S Valley Grove Way	9,725 SF	
1051 S Valley Grove Way	9,377 SF	
1865 W Pleasant Grove Blvd	11,250 SF	
1882 W Pleasant Grove Blvd	10,361 SF	
1926 W Pleasant Grove Blvd	10,467 SF	
758 S North County Blvd	13,125 SF	FUTURE
863 S North County Blvd	9,100 SF	FUTURE
887 S North County Blvd	9,100 SF	FUTURE
Retail L	10,000 SF	FUTURE
Retail M	10,500 SF	FUTURE





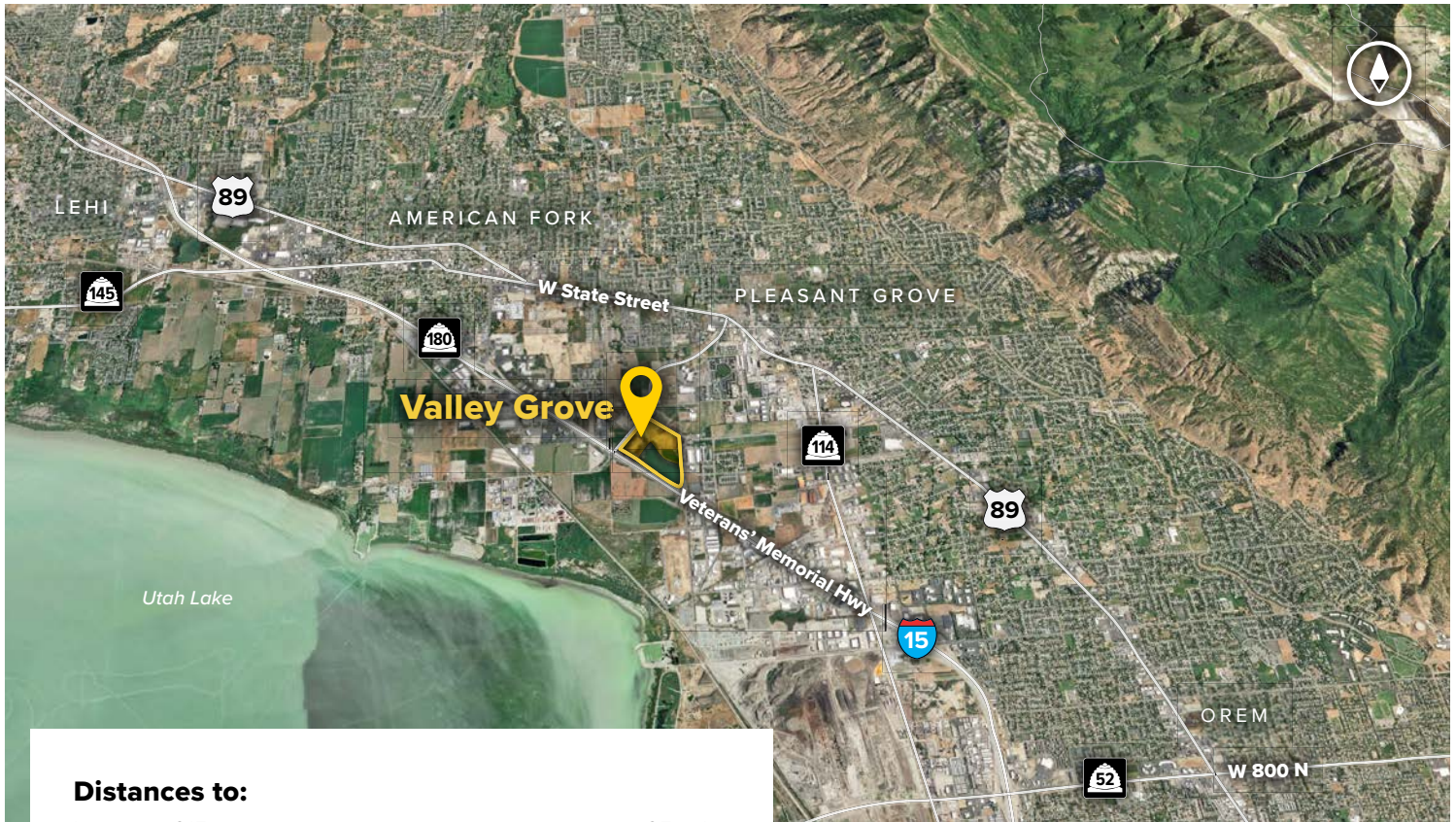

**Distances to:**

- Interstate 215 ..... 25 miles
- Provo, UT (Downtown) ..... 12 miles
- Salt Lake City, UT (Downtown) ..... 34.5 miles
- Salt Lake City International Airport ..... 38 miles



Scan with your mobile device to take a virtual tour, download floor plans and more!

# Contact Us

For additional leasing information or to schedule a tour, contact:

**Scott Gifford**  
 Director of Leasing  
 sgifford@sjpi.com  
 801.899.7991

**Daniel Thomas**  
 Regional Partner, Utah  
 dthomas@sjpi.com  
 801.899.7991

**Utah Office:**  
 1064 S North County Boulevard | Suite 190  
 Pleasant Grove, Utah 84062

**801.899.7991 | SJPI.COM/UTAH**



**About St. John Properties**

St. John Properties Utah owns and is developing more than 1.9 million square feet of commercial space across five business communities in Salt Lake, Weber, and Utah Counties.

St. John Properties, Inc. is one of the nation's largest and most successful privately held commercial real estate firms. Founded in 1971, the vertically-integrated company develops, owns and manages office, flex/ research and development, warehouse, retail and residential space nationwide.

Connect with us @stjohnprop



*This information contained in this publication has been obtained from sources believed to be reliable. St. John Properties makes no guarantee, warranty or representation about this information. Any projections, opinions, assumptions or estimates used here are for example only and do not represent the current or future performance of the property. Interested parties should conduct an independent investigation to determine whether the property suits their needs. REV 10/23*