

Total SF Available:
1,000–12,793 SF

Coming soon! New inline retail space

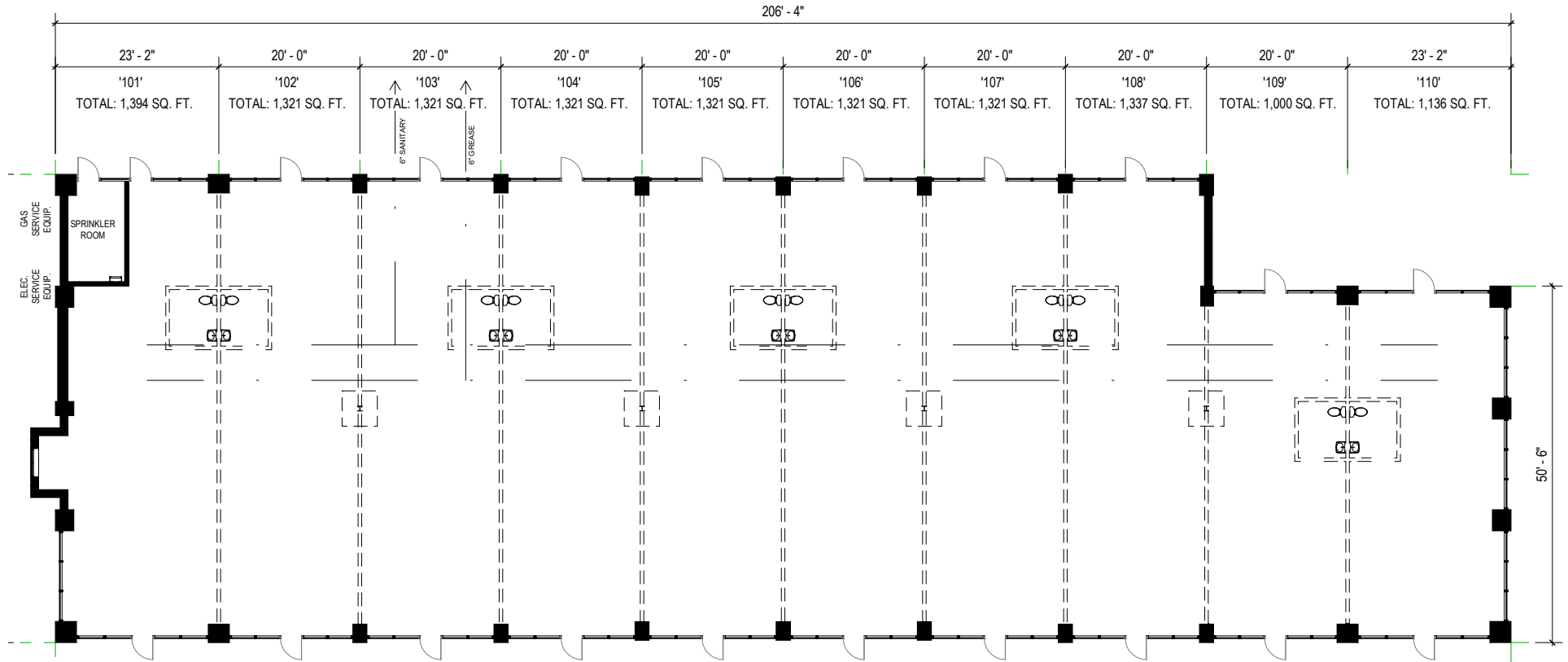

Note: This space plan is subject to existing field conditions. This drawing is proprietary and the exclusive property of St. John Properties, Inc. Any duplications, distribution, or other unauthorized use is strictly prohibited.



910 Cromwell Park Drive

Retail

Inline retail & pad sites

- ▶ Prime access and LED signage visible to 121,110 vehicles per day along Interstate 97
- ▶ Great spot for quick-service restaurants
- ▶ 165-acre business community located directly off Interstate 97 between Baltimore and Annapolis
- ▶ Adjacent to BWI Thurgood Marshall Airport
- ▶ Easy access to Interstates 97, 95, 895 & MD Routes 295, 100, and 176

Traffic Count (MDOT)

Aviation Boulevard:	23,250 vehicles/day
Cromwell Park Drive at Aviation Boulevard:	13,711 vehicles/day
I-97 (Electronic Sign):	121,110 vehicles/day

Demographics

	1 Mile	3 Miles	5 Miles
Population	5,721	88,953	209,684
Avg. Household Income	\$119,611	\$108,068	\$116,888

Inline & Pad Sites Available: *Join Starbucks, Subway, Royal Farms, Chipotle & more!*

910 Cromwell Park Drive

Suites 101–102	Starbucks	2,687 SF
Suite 103	Gibson Schuler	1,631 SF
Suites 104–106	WildFlower + Petal Pusher	3,638 SF
Suite 107	AVAILABLE	1,317 SF
Suite 108	Berkshire Hathaway	1,483 SF

920 Cromwell Park Drive

Suites 101-102	Chipotle	2,458 SF
Suite 103	Charleys	1,614 SF
Suite 104	TropQ Pizza	1,310 SF
Suite 105	Hibachi Express	1,310 SF
Suites 106-108	Heartland Dental	3,898 SF

930 Cromwell Park Drive

Royal Farms

6930 Aviation Boulevard

7-Eleven	2,940 SF
----------	----------

6934 Aviation Boulevard

Suite A	AVAILABLE	3,150 SF
Suite B	AVAILABLE	3,750 SF

6938 Aviation Boulevard

Suites A–C	Los Portales	4,875 SF
Suite D	Aviation Deli & Grill	1,625 SF
Suite E	Subway	1,625 SF

891 Cromwell Park Drive

Suites 101-106	AVAILABLE	8,165 SF
----------------	------------------	----------

901 Cromwell Park Drive

Suites 101-110	AVAILABLE	12,793 SF
----------------	------------------	-----------

Pad Site

Pad Site A	1.0 Acre
------------	----------



Scan with your mobile device to take a virtual tour, download floor plans and more!

Contact Us

For additional information or to schedule a tour, contact:

FLEX/R&D AND OFFICE SPACE:

Bryan Cyphers
Partner in Training
bcyphers@sjpi.com
443.464.1323

Lacey Johansson
Assistant Vice President, Leasing
ljohansson@sjpi.com
410.369.1229

RETAIL SPACE:

Eric Llewellyn
Senior Retail Leasing
Representative
ellewellyn@sjpi.com
443.464.1308

Bill Holzman
Vice President,
Retail Leasing
bholzman@sjpi.com
410.369.1240

Corporate Headquarters:
2560 Lord Baltimore Drive, Baltimore, MD 21244
410.788.0100 | SJPI.COM

About St. John Properties

St. John Properties, Inc. is one of the nation's largest and most successful privately held commercial real estate firms. Founded in 1971, the vertically-integrated company develops, owns and manages office, flex/research and development, warehouse, retail and residential space nationwide.

Connect with us @stjohnprop



This information contained in this publication has been obtained from sources believed to be reliable. St. John Properties makes no guarantee, warranty or representation about this information. Any projections, opinions, assumptions or estimates used here are for example only and do not represent the current or future performance of the property. Interested parties should conduct an independent investigation to determine whether the property suits their needs. REV 02/25