

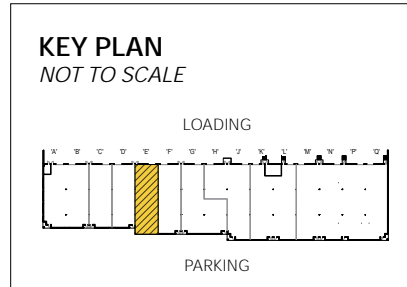

**Total SF Available:**  
2,794 SF

*New flex/R&D shell, drive-in,  
18 ft. clear height*



*Note: This space plan is subject to existing field conditions. This drawing is proprietary and the exclusive property of St. John Properties, Inc. Any duplications, distribution, or other unauthorized use is strictly prohibited.*

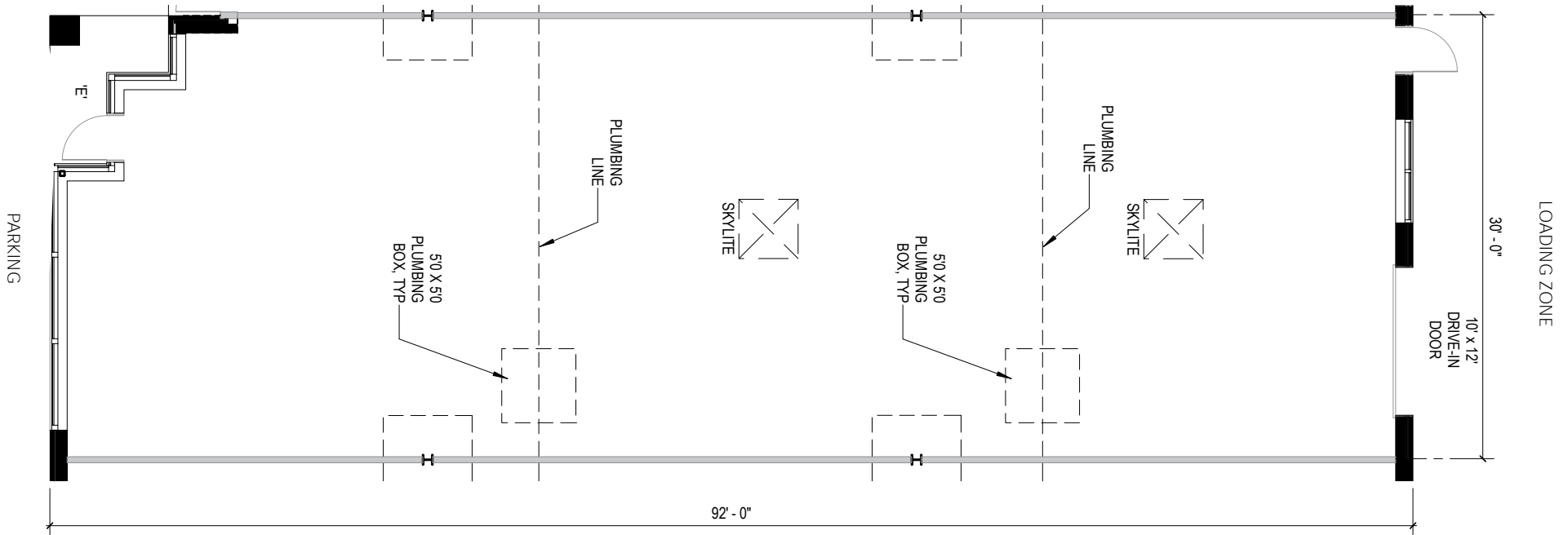



# Contact Us

For additional leasing information or to schedule a tour, contact:

## OFFICE/FLEX SPACE:

### Bill Jauzte

Assistant Vice President,  
Leasing

bjauzte@sjpi.com  
410.369.1213

### Matt Lenihan

Senior Vice President,  
Leasing

mlehan@sjpi.com  
410.369.1202

## RETAIL SPACE:

### Bill Holzman

Vice President, Retail Leasing

bholzman@sjpi.com  
410.369.1240

### Eric Llewellyn

Retail Leasing Representative

ellewellyn@sjpi.com  
443.464.1308

## Corporate Headquarters:

2560 Lord Baltimore Drive, Baltimore, MD 21244  
410.788.0100 | SJPI.COM



Scan with your mobile device to take a virtual tour, download floor plans and more!

## About St. John Properties

St. John Properties, Inc. is a full-service real estate company headquartered in Baltimore, Maryland. The company owns, manages and has developed more than 22 million square feet of commercial real estate, including office, ex/R&D, warehouse, retail and residential space.

Connect with us @stjohnprop

