

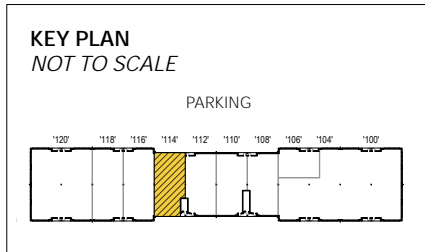

**Total SF Available:**  
2,310 SF

*In-line space with multiple private offices and large conference room*



**Note:** This space plan is subject to existing field conditions. This drawing is proprietary and the exclusive property of St. John Properties, Inc. Any duplications, distribution, or other unauthorized use is strictly prohibited.

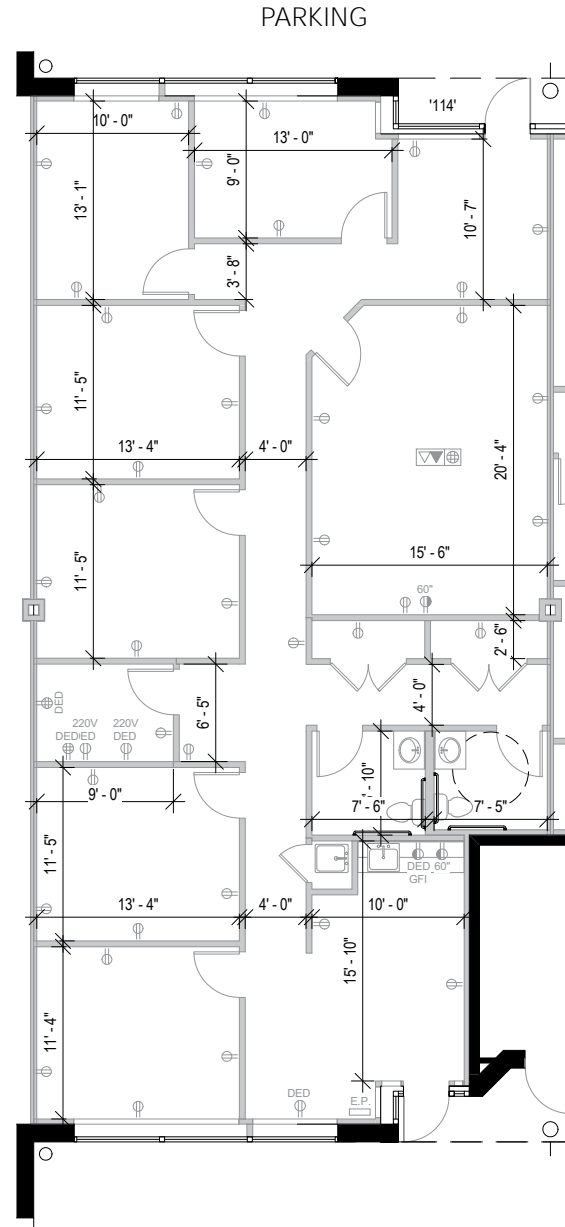





Scan with your mobile device to take a virtual tour, download floor plans and more!

## Contact Us

*For additional leasing information or to schedule a tour, contact:*

**Matt Lenihan**  
 Vice President, Leasing  
 mlenihan@sjpi.com | 410.369.1202

**Corporate Headquarters:**  
 2560 Lord Baltimore Drive  
 Baltimore, MD 21244

**410.788.0100 | SJPI.COM**

### About St. John Properties

St. John Properties, Inc. is a full-service commercial real estate firm headquartered in Baltimore, Maryland. The company has developed, constructed, and owns more than 22 million square feet of commercial real estate, including office, ex/R&D, warehouse, retail and residential space.

Connect with us @stjohnprop

