

Total SF Available:
1,200 SF up to 13,125 SF

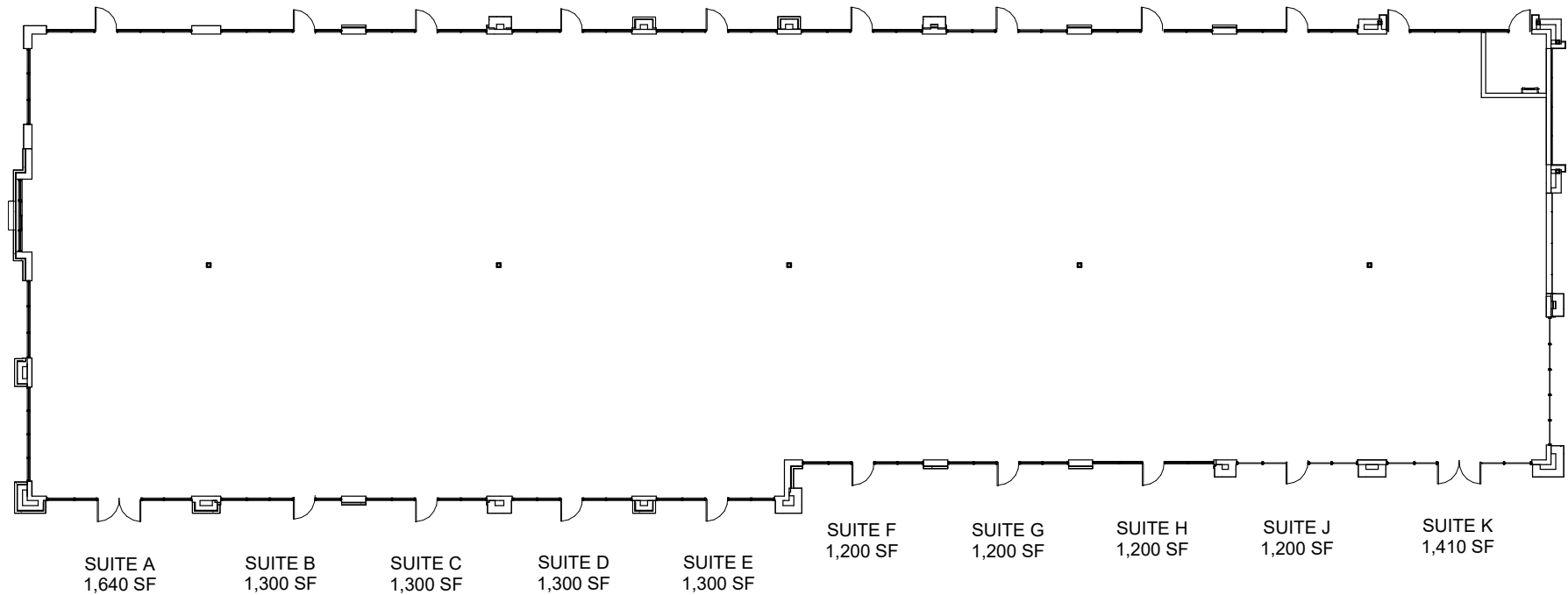



Join Wok The Line, The Village Baker, Starbucks, Jersey Mike's Subs, Gloss Salon, Verizon Wireless, & more!

Inline Retail

Offering drive-thrus & patio seating

Retail Buildings		
875 S North County Blvd	10,000 SF	
1043 S Valley Grove Way	9,725 SF	
1051 S Valley Grove Way	9,377 SF	
1865 W Pleasant Grove Blvd	11,250 SF	
1882 W Pleasant Grove Blvd	10,361 SF	
1926 W Pleasant Grove Blvd	10,467 SF	
Retail A	13,125 SF	FUTURE
Retail J	10,000 SF	FUTURE
Retail K	10,500 SF	FUTURE

Demographics	1 Mile	3 Miles	5 Miles
Population	7,264	61,126	153,817
Avg. Household Income	\$79,953	\$98,766	\$103,753

Traffic Counts
North County Blvd (W 700 N): 21,000+ vehicles/day
Pleasant Grove Blvd: 60,000+ vehicles/day
Interstate 15: 187,000+ vehicles/day



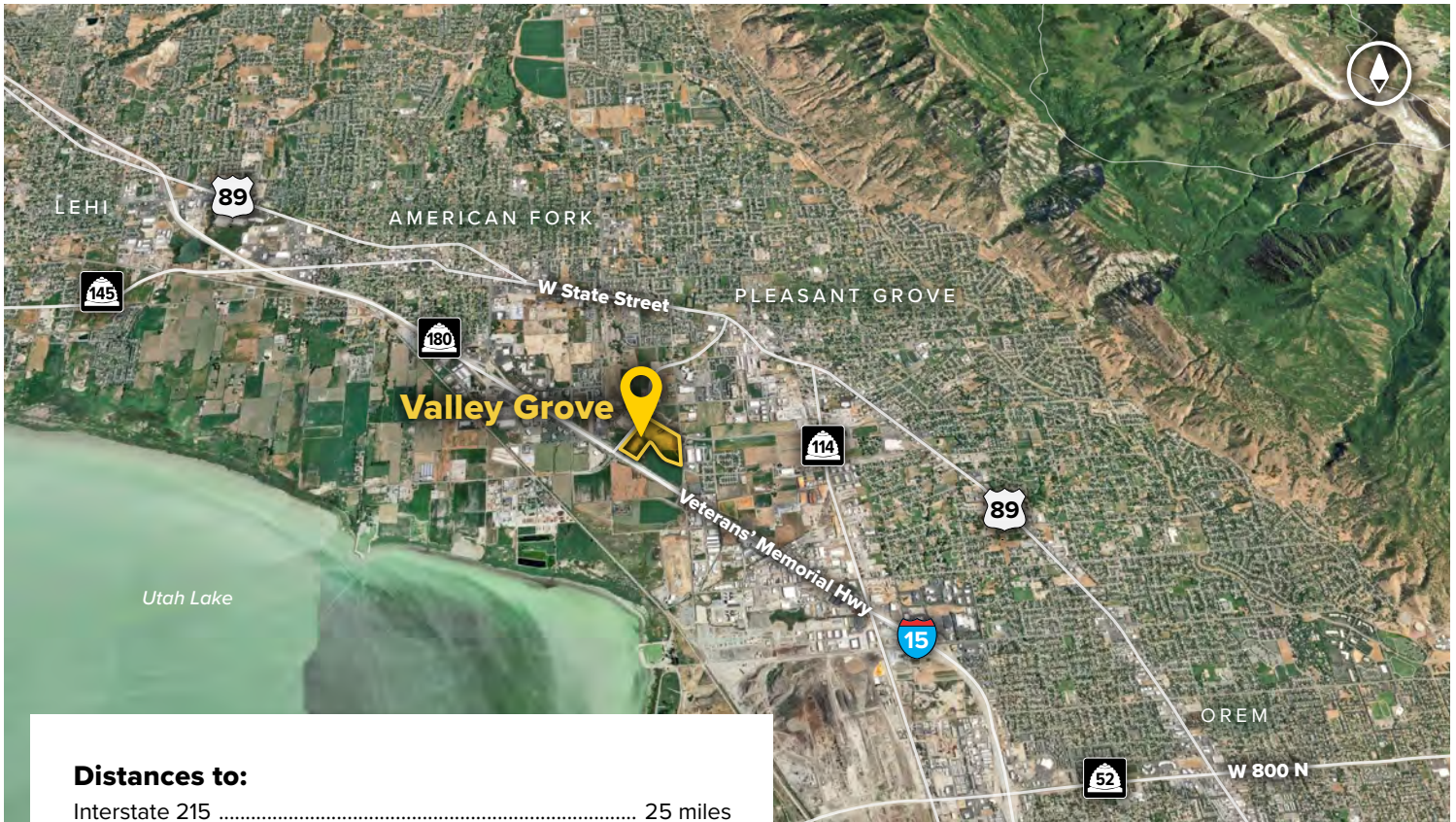

Distances to:

- Interstate 215 25 miles
- Provo, UT 12 miles
- Salt Lake City, UT 34.5 miles
- Salt Lake City International Airport 38 miles



Scan with your mobile device to take a virtual tour, download floor plans and more!

Contact Us

For additional leasing information or to schedule a tour, contact:

Scott Gifford
Leasing Representative
 sgifford@sjpiutah.com
 801.899.7991

Daniel Thomas
Regional Partner, Utah
 dthomas@sjpiutah.com
 801.899.7991

Utah Office:
 1064 S. North County Boulevard | Suite 190
 Pleasant Grove, Utah 84062

801.899.7991 | SJPI.COM/UTAH



About St. John Properties

St. John Properties Utah owns and is developing more than 1.7 million square feet of commercial space across four business communities in Salt Lake, Weber, and Utah Counties.

St. John Properties, Inc. is a full-service real estate company headquartered in Baltimore, Maryland. The company owns, manages and has developed more than 22 million square feet of commercial real estate across nine states.

Connect with us @stjohnprop



This information contained in this publication has been obtained from sources believed to be reliable. St. John Properties makes no guarantee, warranty or representation about this information. Any projections, opinions, assumptions or estimates used here are for example only and do not represent the current or future performance of the property. Interested parties should conduct an independent investigation to determine whether the property suits their needs. REV 06/22