

**Valley Grove**  
2315 West 700 South | Pleasant Grove, UT 84062  
Suites G–H

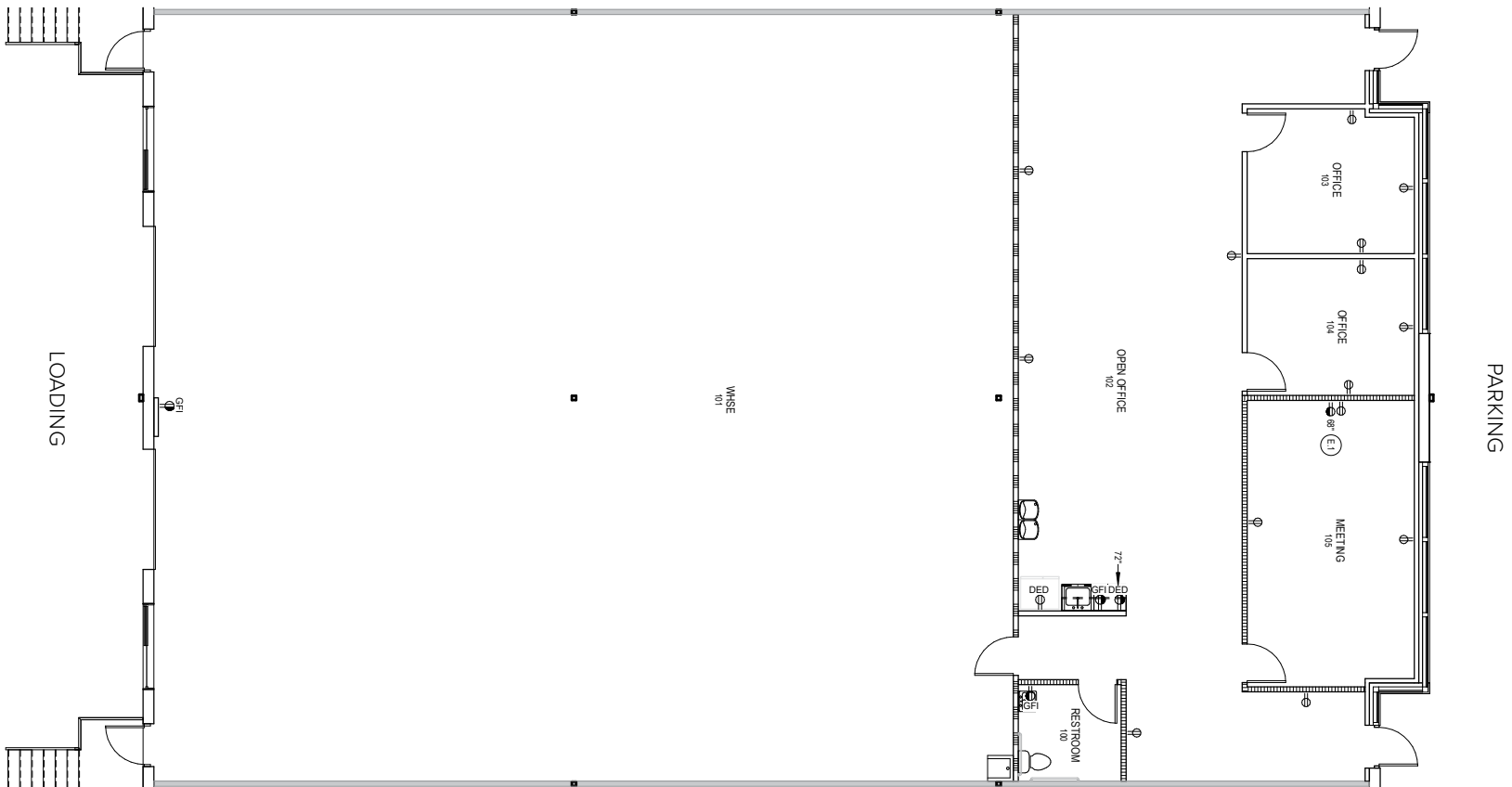

**Total SF Available:**  
6,000 SF

*1,930 sq. ft. office, 4,070 sq. ft. warehouse  
with open office, private offices (2) and  
conference room (1)*





## Flex/R&D

### Direct-Entry Flexible Space

#### Flex/R&D Buildings

2315 West 700 South	48,287 SF
2415 West 700 South	48,287 SF

#### Flex/R&D Specifications

Suite Sizes	Up to 48,287 SF
Ceiling Height	18 ft. clear minimum
Offices	Built to suit
Parking	4 spaces per 1,000 SF





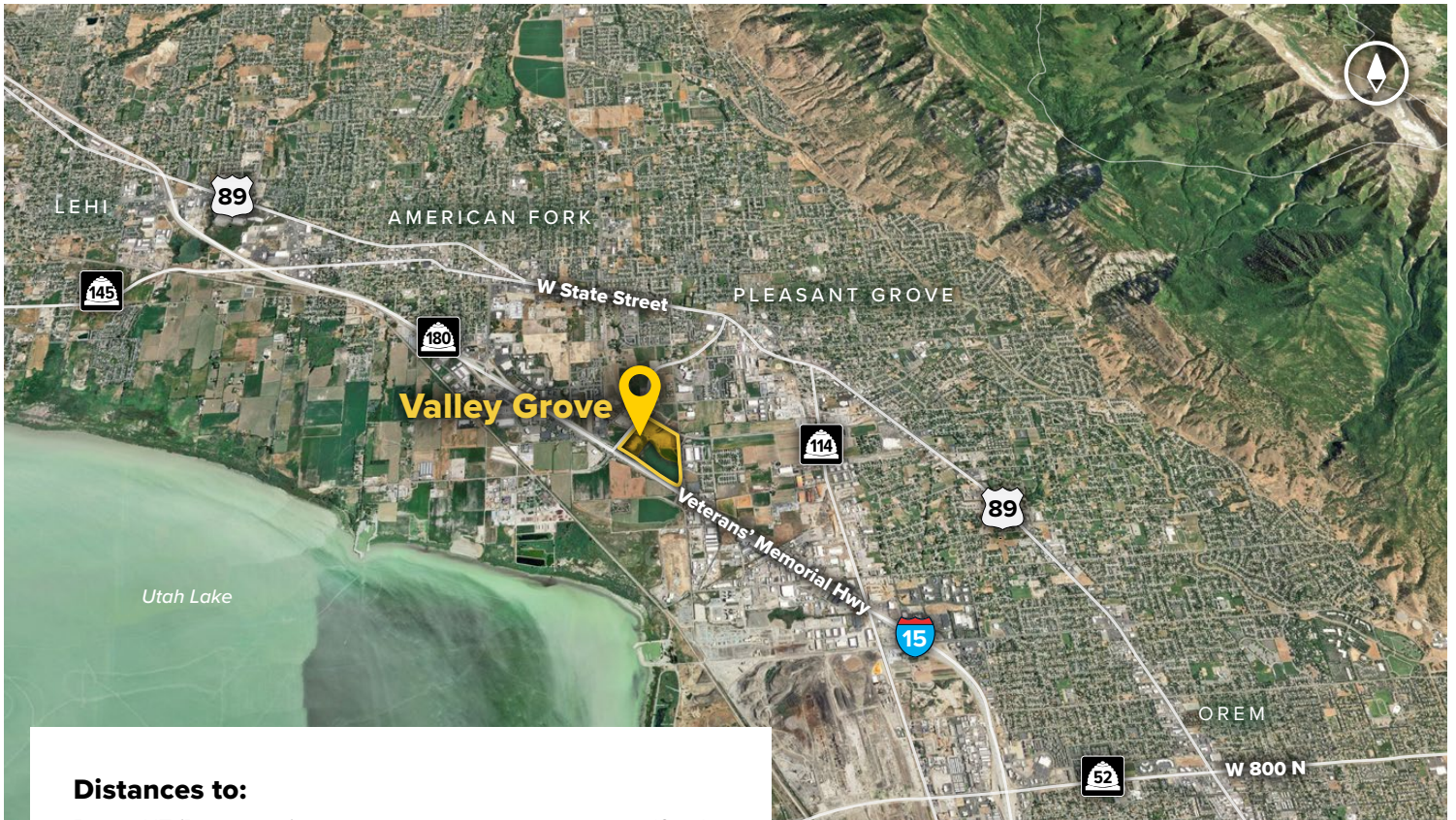

#### Distances to:

Provo, UT (Downtown) .....	12 miles
Interstate 215 .....	25 miles
Salt Lake City, UT (Downtown) .....	34.5 miles
Salt Lake City International Airport .....	38 miles



Scan now to take a virtual tour, download floor plans and more!

## Contact Us

#### Scott Gifford

Assistant Vice President of Leasing  
SGifford@sjpi.com | 801.899.7991

#### Daniel Thomas

Regional Partner  
DThomas@sjpi.com | 801.899.7991

#### Utah Office:

1064 S North County Boulevard | Suite 190  
Pleasant Grove, Utah 84062

801.899.7991 | [SJPI.COM/UTAH](http://SJPI.COM/UTAH)

#### About St. John Properties

St. John Properties, Inc. is one of the nation's largest and most successful privately held commercial real estate firms. Founded in 1971, the vertically-integrated company develops, owns and manages office, flex/ research and development, warehouse, retail and multifamily space nationwide.

Connect with us @stjohnprop



This information contained in this publication has been obtained from sources believed to be reliable. St. John Properties makes no guarantee, warranty or representation about this information. Any projections, opinions, assumptions or estimates used here are for example only and do not represent the current or future performance of the property. Interested parties should conduct an independent investigation to determine whether the property suits their needs. REV 03/25