

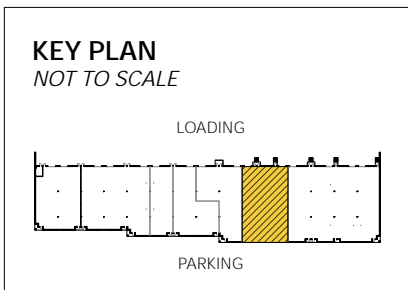

Total SF Available:
2,856–5,712 SF

*New flex/R&D shell space,
18 ft. clear height with two docks*



Note: This space plan is subject to existing field conditions. This drawing is proprietary and the exclusive property of St. John Properties, Inc. Any duplications, distribution, or other unauthorized use is strictly prohibited.

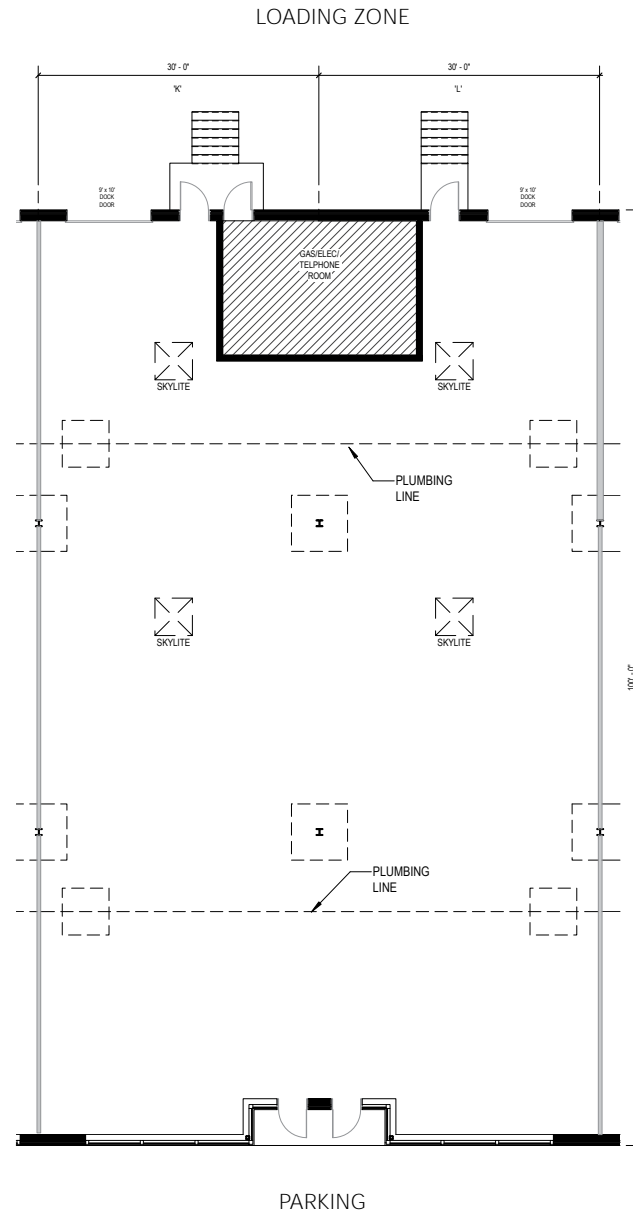

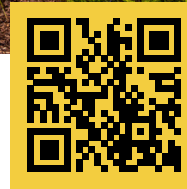

Scan with your mobile device to take a virtual tour, download floor plans and more!

Contact Us

For additional leasing information or to schedule a tour, contact:

RETAIL SPACE:

Bill Holzman

Vice President, Retail Leasing

bholzman@sjpi.com

410.369.1240

Eric Llewellyn

Retail Leasing Representative

ellewellyn@sjpi.com

443.464.1308

OFFICE/FLEX SPACE:

Alaina McCracken

Partner in Training

amccracken@sjpi.com

443.464.1309

Matt Lenihan

Vice President, Leasing

mlehan@sjpi.com

410.369.1202

Corporate Headquarters:

2560 Lord Baltimore Drive, Baltimore, MD 21244

410.788.0100 | SJPI.COM

About St. John Properties

St. John Properties, Inc. is a full-service real estate company headquartered in Baltimore, Maryland. The company owns, manages and has developed more than 22 million square feet of commercial real estate, including office, ex/R&D, warehouse, retail and residential space.

Connect with us @stjohnprop



This information contained in this publication has been obtained from sources believed to be reliable. St. John Properties makes no guarantee, warranty or representation about this information. Any projections, opinions, assumptions or estimates used here are for example only and do not represent the current or future performance of the property. Interested parties should conduct an independent investigation to determine whether the property suits their needs. REV 01/22