



410.788.0100 | SJPI.COM

Greenleigh

11531 Wakefield Street | Middle River, MD 21220

Suites 107–109



Total SF Available:

1,479–5,751 SF

New inline retail in mixed-use community

KEY PLAN NOT TO SCALE

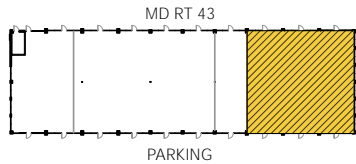

Note: This space plan is subject to existing field conditions. This drawing is proprietary and the exclusive property of St. John Properties, Inc. Any duplications, distribution, or other unauthorized use is strictly prohibited.

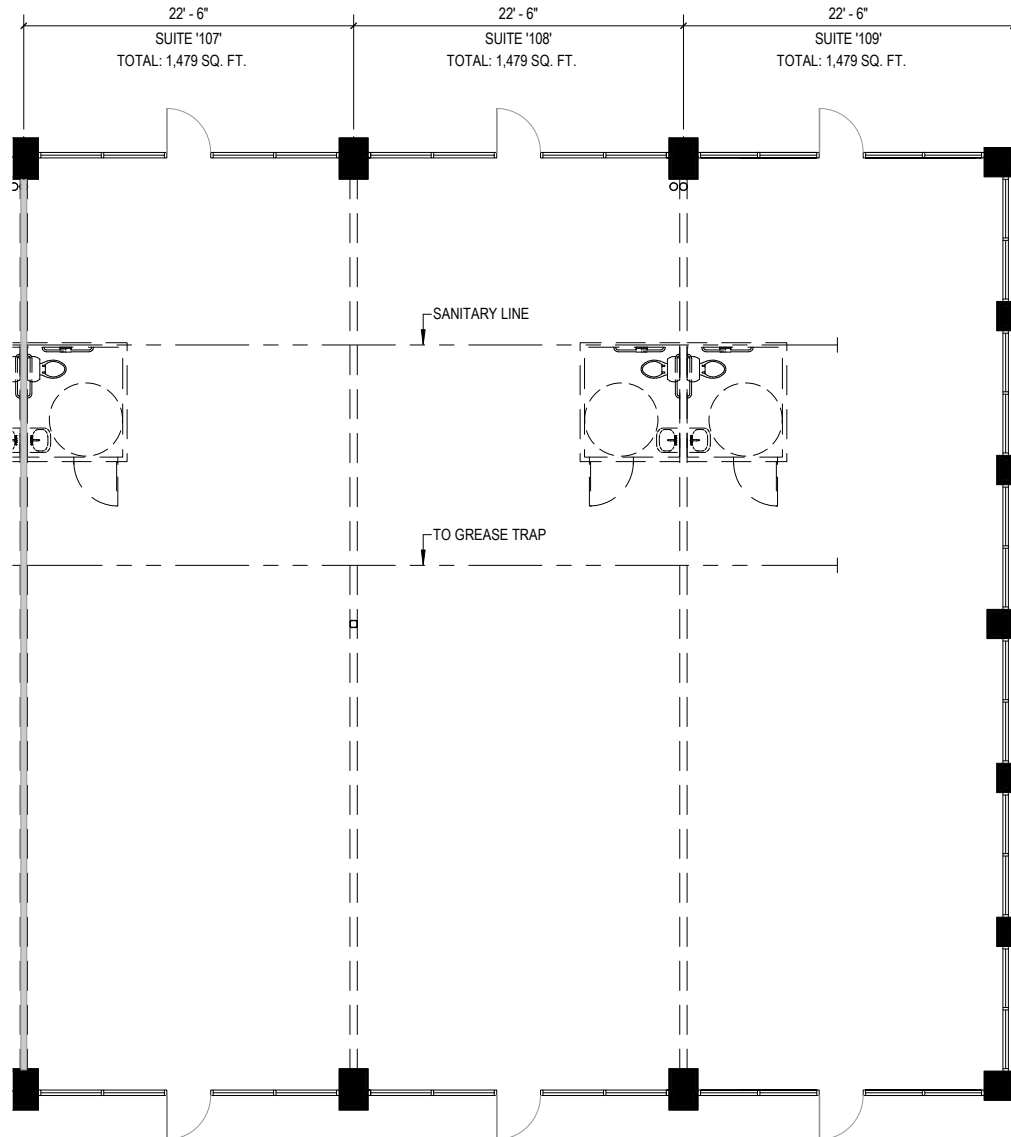

Contact Us

For additional leasing information or to schedule a tour, contact:

OFFICE/FLEX SPACE:

Alaina McCracken

Partner in Training

amccracken@sjpi.com

443.464.1309

Matt Lenihan

Senior Vice President, Leasing

mleihan@sjpi.com

410.369.1202

RETAIL SPACE:

Bill Holzman

Vice President, Retail Leasing

bholzman@sjpi.com

410.369.1240

Eric Llewellyn

Retail Leasing Representative

ellewellyn@sjpi.com

443.464.1308

Corporate Headquarters:

2560 Lord Baltimore Drive, Baltimore, MD 21244

410.788.0100 | SJPI.COM



Scan with your mobile device to take a virtual tour, download floor plans and more!

About St. John Properties

St. John Properties, Inc. is a full-service real estate company headquartered in Baltimore, Maryland. The company owns, manages and has developed more than 22 million square feet of commercial real estate, including office, ex/R&D, warehouse, retail and residential space.

Connect with us [@stjohnprop](https://twitter.com/stjohnprop)

