



Total SF Available:
1,314–13,975 SF

TAKE A VIRTUAL TOUR

Note: This space plan is subject to existing field conditions. This drawing is proprietary and the exclusive property of St. John Properties, Inc. Any duplications, distribution, or other unauthorized use is strictly prohibited.

New inline retail in mixed-use community

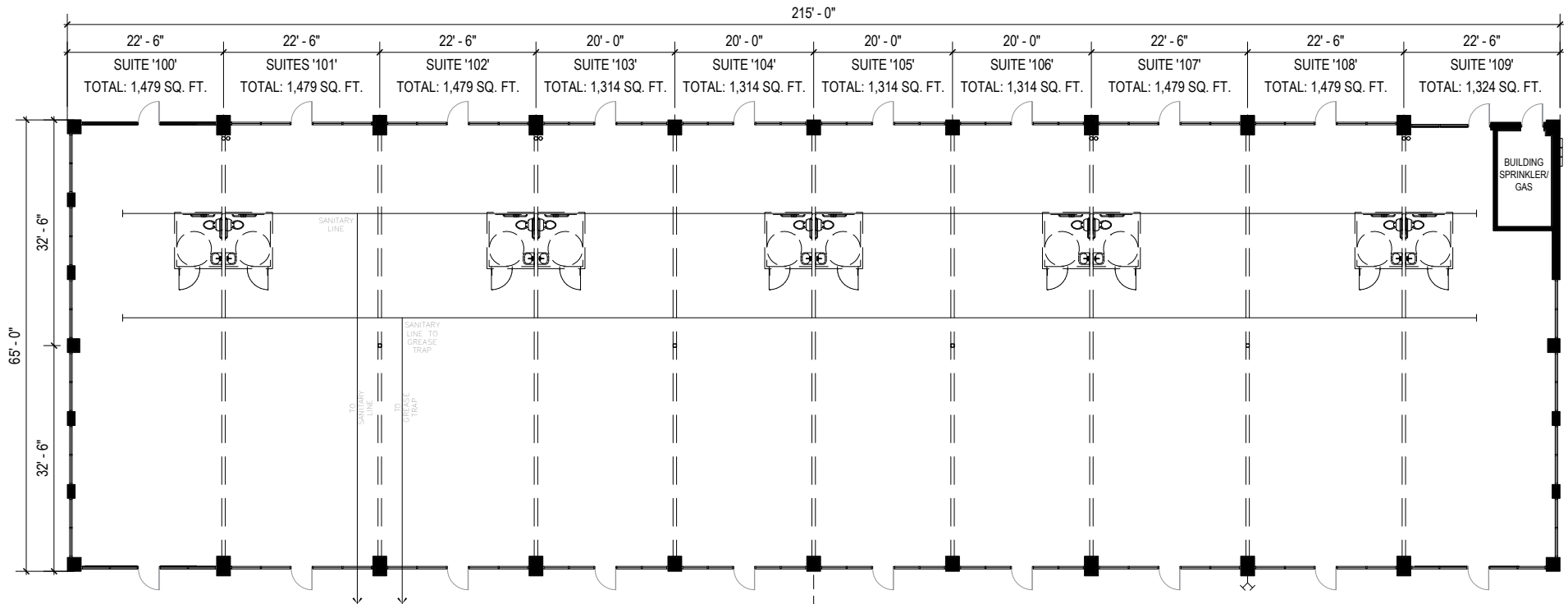

Contact Us

For additional leasing information or to schedule a tour, contact:

OFFICE/FLEX SPACE:

Alaina McCracken
Partner in Training
amccracken@sjpi.com
443.464.1309

Matt Lenihan
Senior Vice President, Leasing
mlenihan@sjpi.com
410.369.1202

RETAIL SPACE:

Bill Holzman
Vice President, Retail Leasing
bholzman@sjpi.com
410.369.1240

Eric Llewellyn
Retail Leasing Representative
ellewellyn@sjpi.com
443.464.1308

Corporate Headquarters:

2560 Lord Baltimore Drive, Baltimore, MD 21244
410.788.0100 | SJPI.COM



Scan with your mobile device to take a virtual tour, download floor plans and more!

About St. John Properties

St. John Properties, Inc. is a full-service real estate company headquartered in Baltimore, Maryland. The company owns, manages and has developed more than 22 million square feet of commercial real estate, including office, ex/R&D, warehouse, retail and residential space.

Connect with us @stjohnprop

