

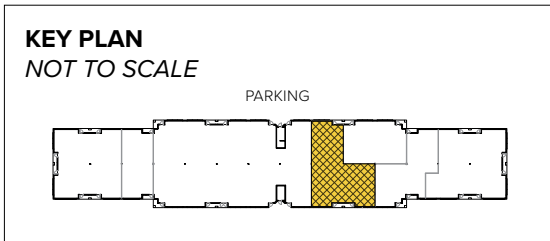

Total SF Available:
3,735 SF

100% office



Note: This space plan is subject to existing field conditions. This drawing is proprietary and the exclusive property of St. John Properties, Inc. Any duplications, distribution, or other unauthorized use is strictly prohibited.

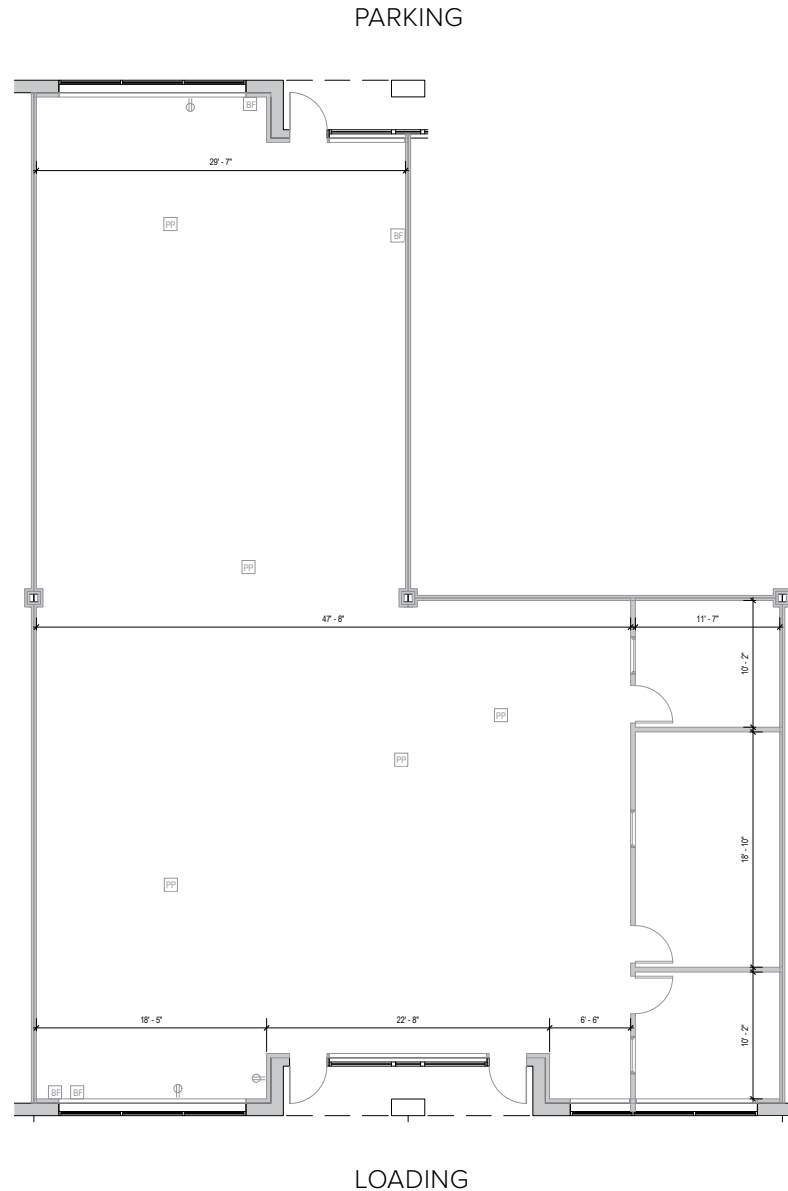



Single-Story Office

Direct-Entry Office

Single-story office buildings at Cromwell Business Park offer direct-entry suites with 24/7 tenant access. Suites feature 9.5 ft. ceiling heights with free, on-site parking at a ratio of 5 spaces per 1,000 square feet.

Single-Story Office Buildings

801 Cromwell Park Drive	32,650 SF
802 Cromwell Park Drive	30,000 SF
811 Cromwell Park Drive	31,980 SF

Single-Story Office Specifications

Suite Sizes	1,005 up to 31,980 SF
Parking	5 spaces per 1,000 SF
Construction	Brick on block
Zoning	C2

For more information on Cromwell Business Park, visit: sjpi.com/cromwell



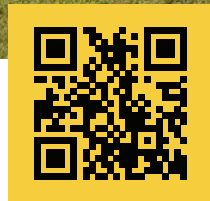

Scan with your mobile device to take a virtual tour, download floor plans and more!

Contact Us

For additional information or to schedule a tour, contact:

FLEX/R&D AND OFFICE SPACE:

Lacey Johansson
Assistant Vice President,
Leasing
ljohansson@sjpi.com
410.369.1229

RETAIL SPACE:

Eric Llewellyn
Retail Leasing Representative
ellewellyn@sjpi.com
443.464.1308

Bill Holzman
Vice President, Retail Leasing
bholzman@sjpi.com
410.369.1240

Corporate Headquarters:

2560 Lord Baltimore Drive, Baltimore, MD 21244
410.788.0100 | SJPI.COM



About St. John Properties

St. John Properties, Inc. is one of the nation's largest and most successful privately held commercial real estate firms. The company owns, manages, and has developed office, flex/research and development, warehouse, retail, and residential space nationwide.

Connect with us @stjohnprop



This information contained in this publication has been obtained from sources believed to be reliable. St. John Properties makes no guarantee, warranty or representation about this information. Any projections, opinions, assumptions or estimates used here are for example only and do not represent the current or future performance of the property. Interested parties should conduct an independent investigation to determine whether the property suits their needs. REV 11/22