

Total SF Available:
150-192 SF

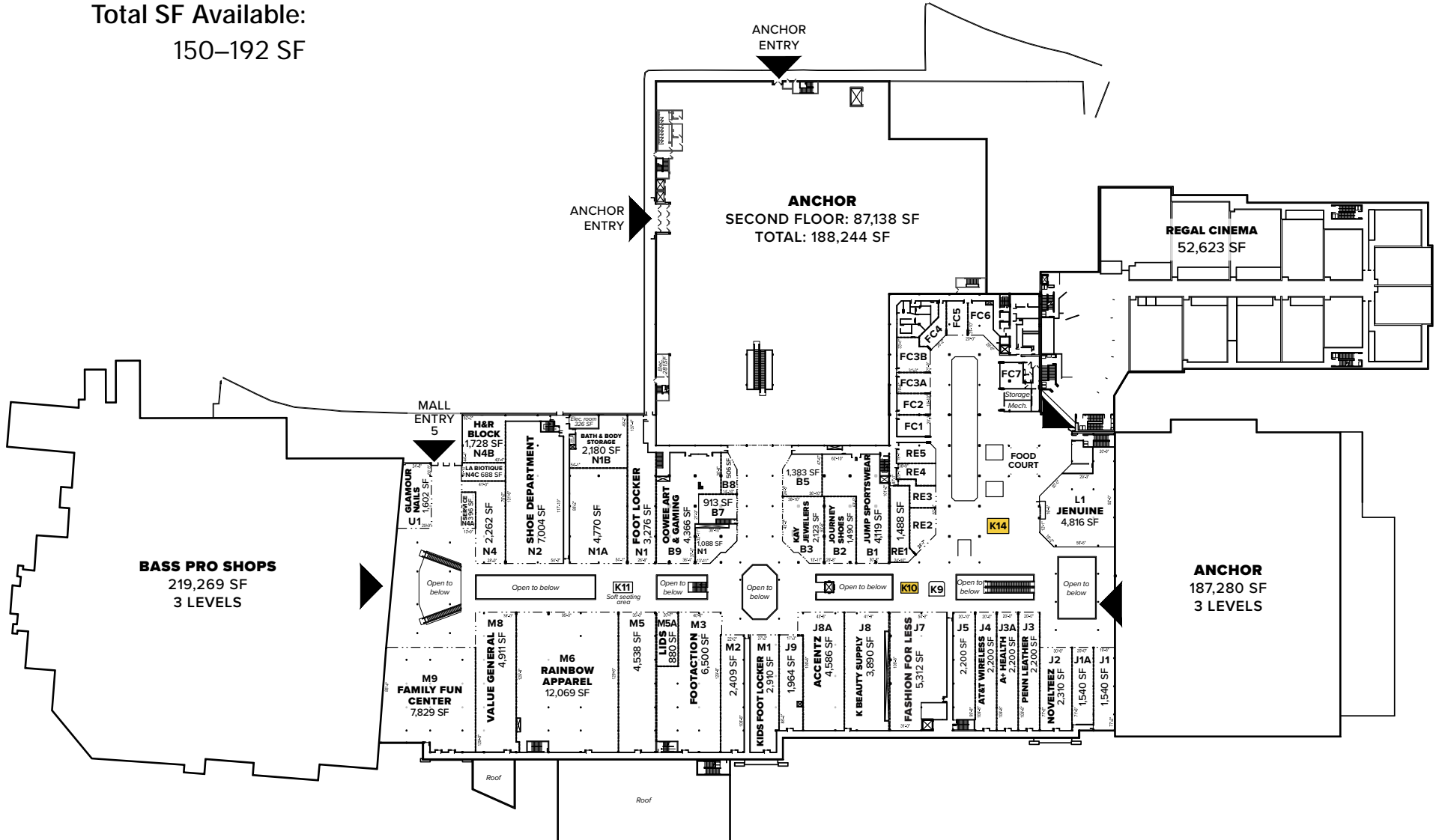

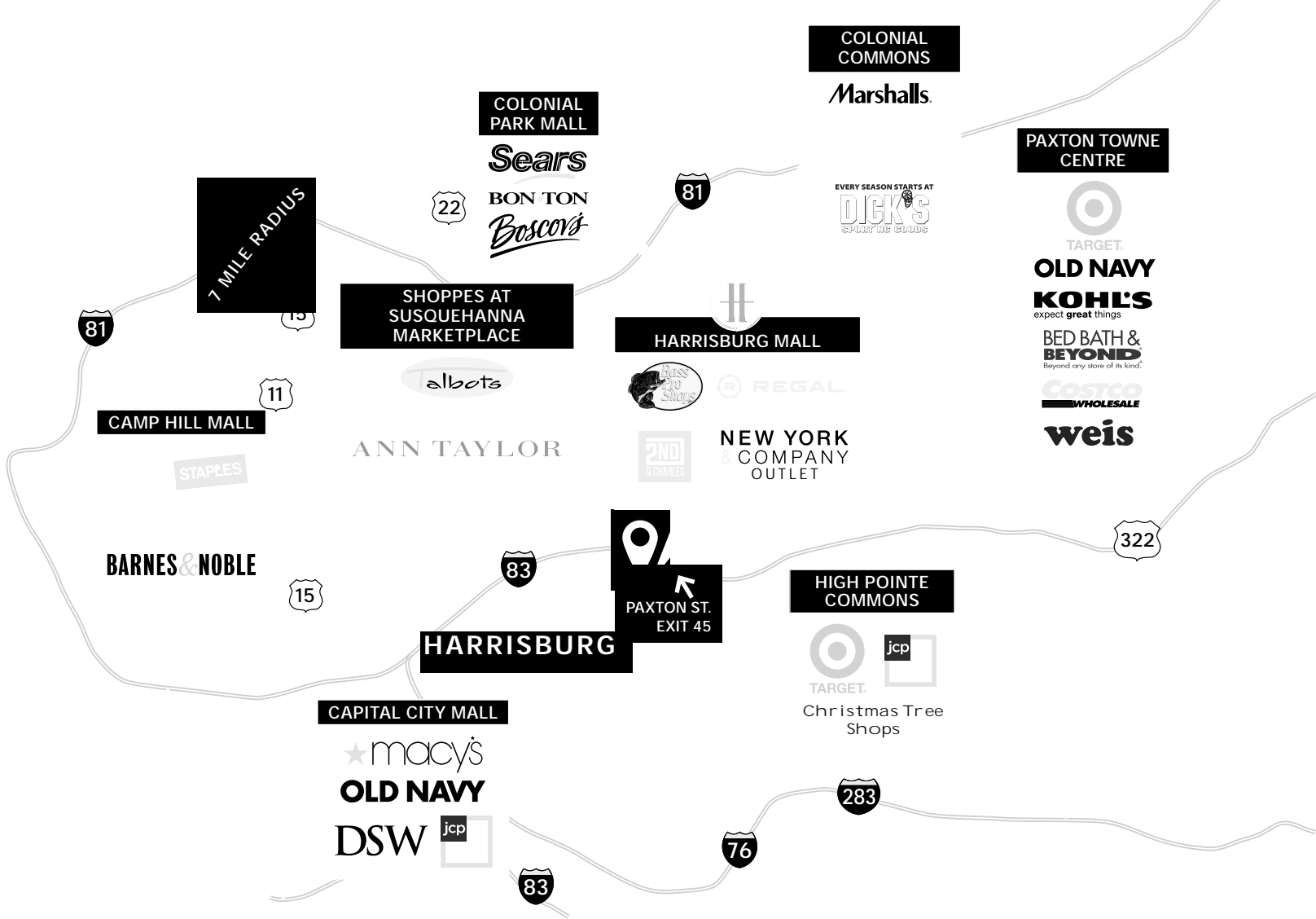

Traffic Counts

I-83 at Paxton Street: 103,317 vehicles/day
 I-83 at I-283 (Capital Beltway): 116,878 vehicles/day

Demographics

| | Population | Households | Average Income |
|---------|------------|------------|----------------|
| 1 Mile | 9,509 | 3,405 | \$65,056 |
| 3 Miles | 74,962 | 31,442 | \$62,186 |
| 5 Miles | 94,316 | 41,892 | \$80,556 |
| 7 Miles | 275,831 | 115,735 | \$82,072 |

Property Data

| | |
|-----------------|--------------|
| Annual Visitors | 4 million |
| Site | 60.05 acres |
| Parking | 4,059 spaces |
| Total Stores | 70 |
| Levels | 2 |

For additional leasing information
 or to schedule a tour, contact:

Bill Holzman
Vice President, Retail Leasing
 410.369.1240 | bholzman@sjpi.com

Eric Llewellyn
Leasing Representative
 443.464.1308 | ellewellyn@sjpi.com

Owned & Managed by:



2560 Lord Baltimore Drive
 Baltimore, MD 21244

410.788.0100 | SJPI.COM

MD | CO | LA | NV | PA | UT | VA | WI

This information contained in this publication has been obtained from sources believed to be reliable. St. John Properties makes no guarantee, warranty or representation about this information. Any projections, opinions, assumptions or estimates used here are for example only and do not represent the current or future performance of the property. Interested parties should conduct an independent investigation to determine whether the property suits their needs. REV 08/20