

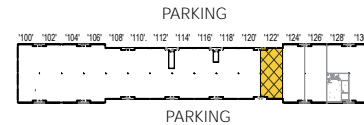

Total SF Available:
2,405 SF

*E*fficient layout with 3 private
*o*ffices and open area

KEY PLAN
NOT TO SCALE



Note: This space plan is subject to existing field conditions. This drawing is proprietary and the exclusive property of St. John Properties, Inc. Any duplications, distribution, or other unauthorized use is strictly prohibited.

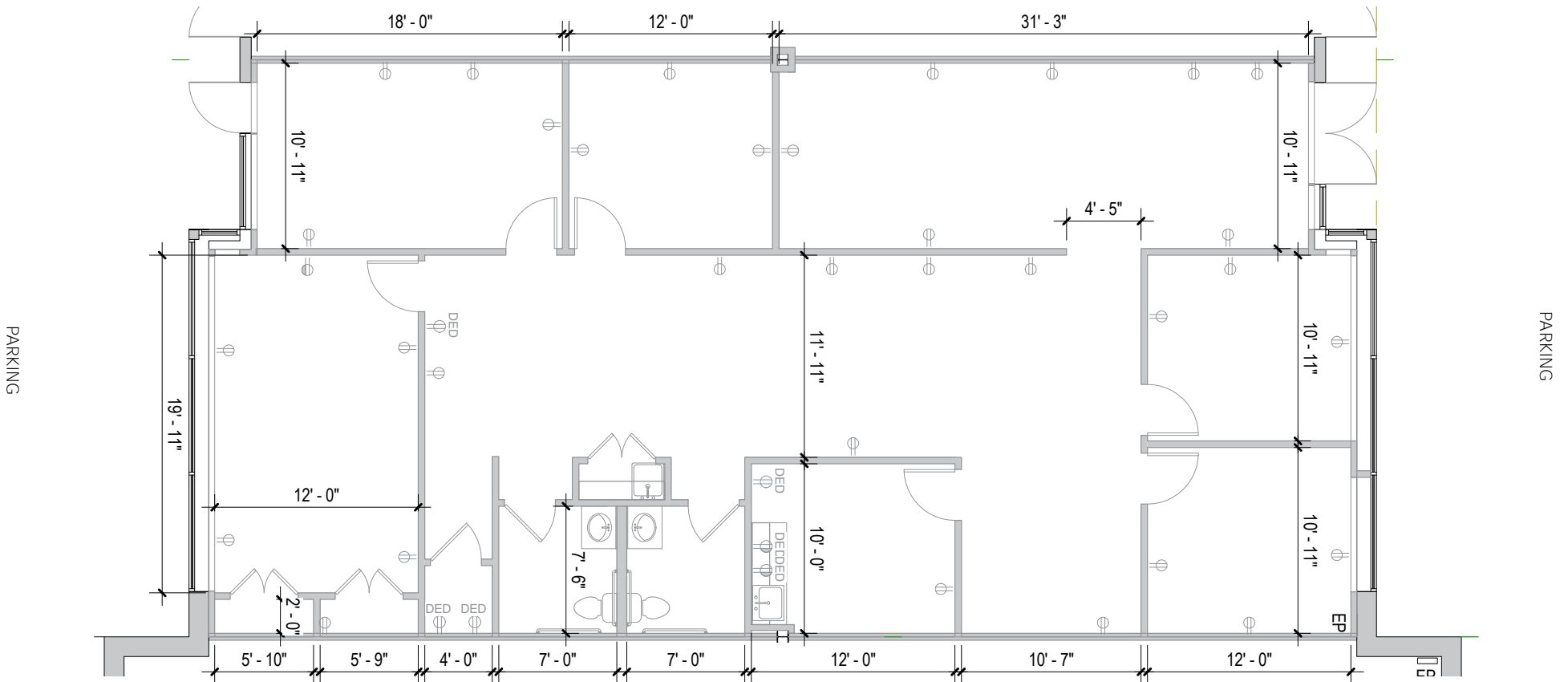

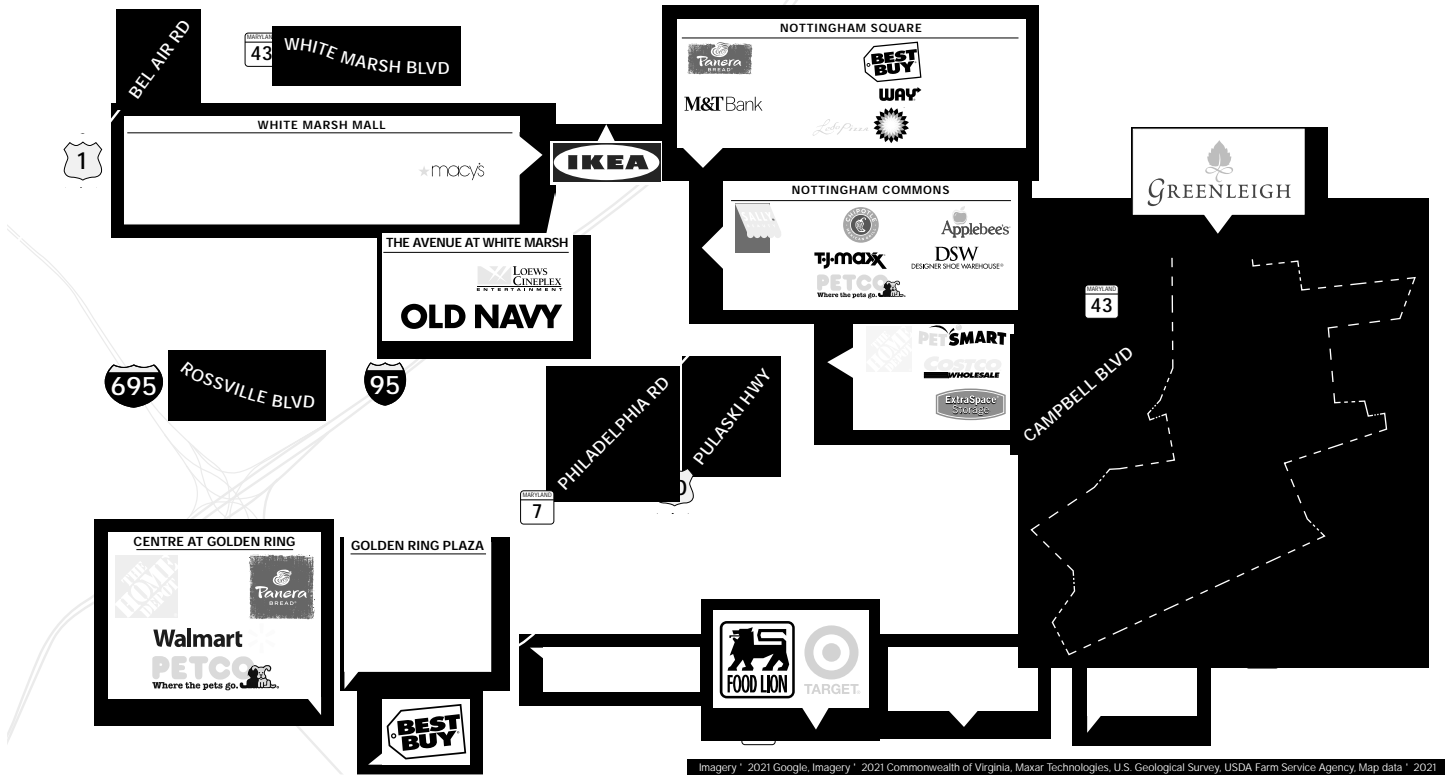

Imagery © 2021 Google, Imagery © 2021 Commonwealth of Virginia, Maxar Technologies, U.S. Geological Survey, USDA Farm Service Agency, Map data © 2021

Distances to:

- Baltimore, MD (Downtown) 14 miles
- Columbia, MD 18 miles
- Hunt Valley, MD 9 miles
- Interstate 70 11 miles
- Interstate 95 15 miles
- Interstate 695 (Baltimore Beltway) 5 miles
- Mill Station/Metro Centre 4 miles



Scan with your mobile device to take a virtual tour, download floor plans and more!

Contact Us

For additional leasing information or to schedule a tour, contact:

RETAIL SPACE:

Bill Holzman Vice President, Retail Leasing bholzman@sjpi.com 410.369.1240	Eric Llewellyn Retail Leasing Representative ellewellyn@sjpi.com 443.464.1308
--	---

OFFICE/FLEX SPACE:

Matt Lenihan
Vice President, Leasing
mlenihan@sjpi.com
410.369.1202

Corporate Headquarters:
2560 Lord Baltimore Drive, Baltimore, MD 21244
410.788.0100 | SJPI.COM

About St. John Properties

St. John Properties, Inc. is a full-service real estate company headquartered in Baltimore, Maryland. The company owns, manages and has developed more than 21 million square feet of commercial real estate, including office, ex/R&D, warehouse, retail and residential space.

Connect with us @stjohnprop



This information contained in this publication has been obtained from sources believed to be reliable. St. John Properties makes no guarantee, warranty or representation about this information. Any projections, opinions, assumptions or estimates used here are for example only and do not represent the current or future performance of the property. Interested parties should conduct an independent investigation to determine whether the property suits their needs. REV 05/21